

SURVEY &
REMONUMENTATION

FEB 18 1994

OTTAWA COUNTY REMONUMENTATION
LAND CORNER RECORDATION CERTIFICATE
Filing Requirement of Act 74, Mich. P.A. 1970

RECORDED

93 NOV -8 PM 1:59

Ralph S. Hallman
REGISTER OF DEEDS
OTTAWA COUNTY, MI

COMMISSION
For corners in

Ottawa (County)	Located In:	Corner Code #
1. Public Land Survey	T 9N R 13W	C-7, SW Cor. Sec. 17, Chester
	T _____ R _____	_____
	T _____ R _____	_____
	T _____ R _____	_____
2. Property Controlling in Section	S _____ T _____ R _____	_____
	S _____ T _____ R _____	_____
3. Miscellaneous Property in Sec.	S _____ T _____ R _____	_____
	S _____ T _____ R _____	_____

Register of Deeds Stamp & File Number

4. Lot No. _____, Recorded Plat _____
5. Private Claims _____

	A	B	C	D	E	F	G	H	I	J	K	L	M
2	6	5	4	3	2	1							
3													
4	7	8	9	10	11	12							
5													
6	18	17	16	15	14	13							
7													
8	19	20	21	22	23	24							
9													
10	30	29	28	27	26	25							
11													
12	31	32	33	34	35	36							
13													

I, Randal D. Feenstra, in a field survey on October 14, 19 93, do hereby certify that under requirements of P.A. 74, Michigan P.A. of 1970, the corner points mentioned in lines 1 and 2 above were in conformance with regulations and rules therefore as required in the current manual of survey instructions of the United States Department of the Interior, Bureau of Land Management or by a decree of a Court of Law and/or that the corner points mentioned in lines 3, 4 and 5 above were in conformance with the rules of the Michigan Board of Land Surveyors or by a Decree of a Court of Law; established, re-established, monumented, re-monumented, recovered, found as expressed below:

NOTE: Not more than 4 corners, all in the same town and range, may be recorded on this certificate.

A. Description of original monument and accessories and/or subsequent restoration:

C-7:
L.C.R.C.# L-4, P-334 (9-22-82)
C.I. Monument
SW Cor, Conc. Blk. Structure NE 63.04'
CL Stop sign NW 49.23'
CL Street sign SE 54.24'
P. Pole SW 61.30'

B. Description of corner evidence found and/or method applied in restoring or reestablishing corner:

C-7: Found Cast Iron Monument in Box - accepted as a careful and faithful perpetuation of the position of the original corner.
SW cor, conc. blk. structure N40°E 63.11'
PK in E. side P.P: S45°W 61.20'

C. Description of monument for corner and accessories established to perpetuate locating the position of the corner:

C-7: Cast Iron Monument in Box
O.C. Remon. Nail & Tag in W. side 16" Maple S20°E 104.52'
O.C. Remon. Nail & Tag in E. side P.P. S45°W 61.40'
SW cor conc. block well house N40°E 63.11'
"X" in W. end 12' conc. culvert N65°E 75.65'

1.5' N. of CL "X" 40th Ave. & Gooding Street

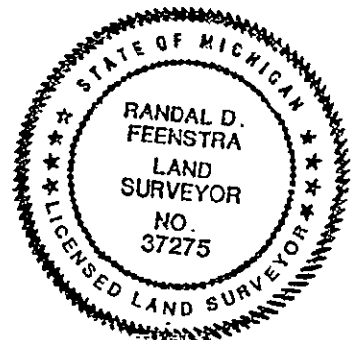

Signed by *Randal D. Feenstra* Date 10-18-93

Surveyor's Michigan License No. 37275