

**SURVEY & REMONUMENTATION**

APR 05 1996

COMMISSION

**OTTAWA COUNTY REMONUMENTATION**

LAND CORNER RECORDATION CERTIFICATE  
Filing Requirement of Act 74, Mich. P.A. 1970

For corners in  
Ottawa

Located In:

Corner Code #

(County)	Located In:	Corner Code #
1. Public Land Survey	Chester Twp. 9N 13W	C-10, E 1/4 cor. Sec. 30
	T ___ R ___	_____
	T ___ R ___	_____
	T ___ R ___	_____
	T ___ R ___	_____
2. Property Controlling in Section	S ___ T ___ R ___	_____
	S ___ T ___ R ___	_____
3. Miscellaneous Property in Sec.	S ___ T ___ R ___	_____
	S ___ T ___ R ___	_____

RECORDED  
95 NOV 29 PM 1:36

*Debra A. Robinson*  
REGISTER OF DEEDS  
OTTAWA COUNTY, MI

Register of Deeds Stamp & File Number

4. Lot No. \_\_\_\_\_, Recorded Plat \_\_\_\_\_  
5. Private Claims \_\_\_\_\_

1	A	B	C	D	E	F	G	H	I	J	K	L	M
2		6		5		4		3		2		1	
3													
4		7		8		9		10		11		12	
5													
6		18		17		16		15		14		13	
7													
8		19		20		21		22		23		24	
9													
10		30		29		28		27		26		25	
11													
12		31		32		33		34		35		36	
13													

I, Randal D. Feenstra, in a field survey on Nov. 6, 1995 do hereby state that under requirements of P.A. 74, Michigan P.A. of 1970, the corner points mentioned in lines 1 and 2 above were in conformance with regulations and rules therefore as required in the current manual of survey instructions of the United States Department of the Interior, Bureau of Land Management or by a decree of a Court of Law and/or that the corner points mentioned in lines 3, 4 and 5 above were in conformance with the rules of the Michigan Board of Land Surveyors or by a Decree of a Court of Law; established, re-established, monumented, recovered, found as expressed below:

NOTE: Not more than 2 corners, all in the same town and range, may be recorded on this certificate.

A. Description of original monument and accessories and/or subsequent restoration:

G.L.O. (1838)	L-4, P-266, (1981)		
Rasselas Whitcomb	C.I.M.	NW	30.45'
4" Ironwood N7°W 20 lks.	RR X-ing Sign	SW	31.35'
12" Elm S 9°E 36 lks	N edge RR Rail @90° to Sec. Cor.	SSE	140.66'
	RR X-ing Sign	E	79.47'
	Tw. 14" Cherry		

B. Description of corner evidence found and/or method applied in restoring or reestablishing corner:

Found: C.I.M. in box Accepted as a careful and faithful perpetuation of the position of the original corner.  
No witnesses found

PA. 345 OTTAWA COUNTY  
PEER APPROVED 11/20/95

*Andrey D. Nedeveld*  
ADN

C. Description of monument for corner and accessories established to perpetuate locating the position of the corner:

C-10	C.I.M. in box		
	Ottawa County Remon Nail & Tag in N side 16" Tw. Cherry	87°	78.88'
	Ottawa County Remon Nail & Tag in W side 6" Tw. Poplar	22°	112.57'
	Ottawa County Remon Nail & Tag in NE side P. Pole	304°	191.64'
	Ottawa County Remon. Nail & Tag in SE side P. Pole	241°	260.00'

on centerline 40th Ave.

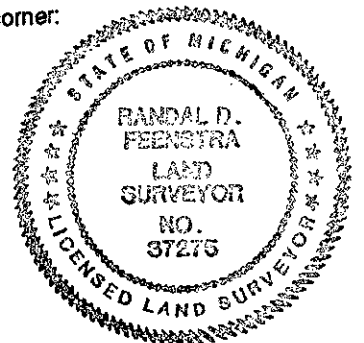

Signed by Randal D. Feenstra  
Surveyor's Michigan License No. 37275

Date November 6, 1995