

SURVEY &  
REMONUMENTATION

OCT 24 1994

COMMISSION

OTTAWA COUNTY REMONUMENTATION  
LAND CORNER RECORDATION CERTIFICATE  
Filing Requirement of Act 74, Mich. P.A. 1970

RECORDED

94 OCT -7 PM 12:32

*Ralph D. Redmond*  
REGISTER OF DEEDS  
OTTAWA COUNTY, MI

For corners in

Ottawa

(County)

Located In:

Corner Code #

- |                                    |      |       |                  |
|------------------------------------|------|-------|------------------|
| 1. Public Land Survey              | T 9N | R 13W | C-13, SW COR     |
|                                    | T    | R     | Sec. 32, Chester |
|                                    | T    | R     |                  |
|                                    | T    | R     |                  |
| 2. Property Controlling in Section | S    | T     | R                |
|                                    | S    | T     | R                |
| 3. Miscellaneous Property in Sec.  | S    | T     | R                |
|                                    | S    | T     | R                |

Register of Deeds Stamp & File Number

4. Lot No. \_\_\_\_\_, Recorded Plat \_\_\_\_\_  
5. Private Claims \_\_\_\_\_

A	B	C	D	E	F	G	H	I	J	K	L
2	6	5	4	3	2	1					
3											
4	7	8	9	10	11	12					
5											
6	16	17	16	15	14	13					
7											
8	19	20	21	22	23	24					
9											
10	30	29	28	27	26	25					
11											
12	31	32	33	34	35	36					
13											

I, Randal D. Feenstra in a field survey on May 9, 1994, do hereby certify that under requirements of P.A. 74, Michigan P.A. of 1970, the corner points mentioned in lines 1 and 2 above were in conformance with regulations and rules therefore as required in the current manual of survey instructions of the United States Department of the Interior, Bureau of Land Management or by a decree of a Court of Law and/or that the corner points mentioned in lines 3, 4 and 5 above were in conformance with the rules of the Michigan Board of Land Surveyors or by a Decree of a Court of Law; established, re-established, monumented, re-monumented, recovered, found as expressed below:

**NOTE: Not more than 4 corners, all in the same town and range, may be recorded on this certificate.**

A. Description of original monument and accessories and/or subsequent restoration:

G.L.O. (1838)	Liber 3, Page 100 (1976)	Liber 6, Page 116 (1991)
30" Beech N45°W 36.3	TP IRON	CIM in Mon. Box
18" Sugar N47°E 14.5	TP SW 30.24	NE Cor. Sec. 6-8-13 E 52.02
POST	15" Hickory S 91.90	Nail in Wood post NE 57.69
Rasselas Whitcomb	Fence Post NE 57.45	Pk. in TP SSW 30.61
		Nail in 18" Hickory SSE 91.89

B. Description of corner evidence found and/or method applied in restoring or reestablishing corner:

Found: Cast Iron Mon. in Mon. Box - accepted as a careful and faithful perpetuation of the position of the original corner.

Found Witnesses:

PK in NW side PP	SW 30.58'
Nail in NW side 24" Hickory	S 91.81'
Nail in NW side fence post	NE 57.68'
NE cor., Sec. 6, T8N, R13 W	E 51.98'

PA. 345 OTTAWA COUNTY  
PEER APPROVED *[Signature]*  
*[Signature]*

C. Description of monument for corner and accessories established to perpetuate locating the position of the corner:

C-13 Cast Iron Mon. in Mon. Box	
O.C. Remon. Nail & tag in NW side PP	S25°W 30.45'
O.C. Remon. Nail & tag in NE side 24" Hickory	S15°E 91.83'
O.C. Remon. Nail & tag in SE side fence post	N60°E 57.66'
Wright Township corner	N90°E 51.98'
ON CL Wilson E CL 40th to North.	

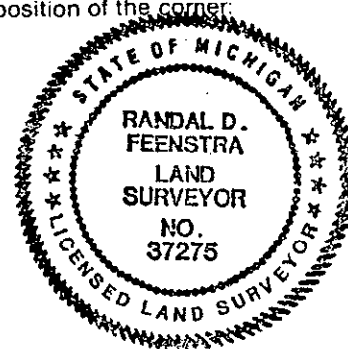

Signed by Randal D. Feenstra

Date May 9, 1994

Surveyor's Michigan License No. 37275