

RECORDED

RECORDED

FEB 18 1994

OTTAWA COUNTY REMONUMENTATION
LAND CORNER RECORDATION CERTIFICATE
Filing Requirement of Act 74, Mich. P.A. 1970

93 NOV -8 PM 1:59

R. D. Feenstra
REGISTER OF DEEDS
OTTAWA COUNTY, MI

For corners in

Ottawa

(County)

Located In:

Corner Code #

- 1. Public Land Survey T 9N R 13W D-5, N $\frac{1}{2}$ COR.
T _____ R _____ Sec. 17, Chester
T _____ R _____
T _____ R _____
- 2. Property Controlling S _____ T _____ R _____
in Section S _____ T _____ R _____
3. Miscellaneous S _____ T _____ R _____
Property in Sec. S _____ T _____ R _____

Dep #1 per

Register of Deeds Stamp & File Number

- 4. Lot No. _____, Recorded Plat _____
- 5. Private Claims _____

A	B	C	D	E	F	G	H	I	J	K	L	M
2	5	5	4	3	2	1						
3												
4	7	8	9	10	11	12						
5												
6	16	17	16	15	14	13						
7												
8	19	20	21	22	23	24						
9												
10	30	29	28	27	26	25						
11												
12	31	32	33	34	35	36						
13												

I, Randal D. Feenstra, in a field survey on October 14, 19 93, do hereby certify that under requirements of P.A. 74, Michigan P.A. of 1970, the corner points mentioned in lines 1 and 2 above were in conformance with regulations and rules therefore as required in the current manual of survey instructions of the United States Department of the Interior, Bureau of Land Management or by a decree of a Court of Law and/or that the corner points mentioned in lines 3, 4 and 5 above were in conformance with the rules of the Michigan Board of Land Surveyors or by a Decree of a Court of Law; established, re-established, monumented, re-monumented, recovered, found as expressed below:

NOTE: Not more than 4 corners, all in the same town and range, may be recorded on this certificate.

A. Description of original monument and accessories and/or subsequent restoration:

- D-5: L.C.R.C.# L-2, P-820 (5-1-75) Steel Bar 36" Maple NE 38.80 30" Maple ENE 89.17'
- L.C.R.C.# L-4, P-225 (10-13-81) Cast Iron Monument 36" Maple NE 38.50' 36" Maple NNE 88.39' Buried Cable Sign N 19.60'

B. Description of corner evidence found and/or method applied in restoring or reestablishing corner:

- D-5: Found Cast Iron Monument - accepted as a careful and faithful perpetuation of the position of the original corner.
- Nail in S. side 36" Maple N75°E 88.28'
- Buried Cable Sign N5°W 19.54'

C. Description of monument for corner and accessories established to perpetuate locating the position of the corner:

- D-5: Cast Iron Monument
- O.C. Remon. Nail & Tag in S. side 36" Maple N75°E 88.25'
- O.C. Remon. Nail & Tag in W. side 36" Maple N45°E 38.53'
- O.C. Remon. Nail & Tag in E. side 14" Elm S10°W 46.42'
- O.C. Remon. Nail & Tag in SW side 12" Maple N25°W 32.26'
- 5' N. of CL Hoover
- Tree lines to N. & S.

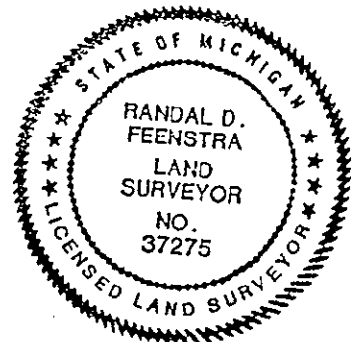

Signed by *Randal D. Feenstra*

Date 10-18-93

Surveyor's Michigan License No. 37275