

OTTAWA COUNTY REMONUMENTATION

RECORDED

LAND CORNER RECORDATION CERTIFICATE
Filing Requirement of Act 74, Mich. P.A. 1970

94 DEC -8 PM 12:39

D. J. ...
REGISTER OF DEEDS
OTTAWA COUNTY, MI

For corners in

Ottawa
(County)

Located In:
Chester

Corner Code #

1. Public Land Survey

T 9N R 13W

D-5, S/4

Cor, Sec. 8

T R

T R

T R

2. Property Controlling
in Section

S T R

S T R

3. Miscellaneous
Property in Sec.

S T R

S T R

Sept 22 pm

Register of Deeds Stamp & File Number

4. Lot No. _____, Recorded Plat _____

5. Private Claims _____

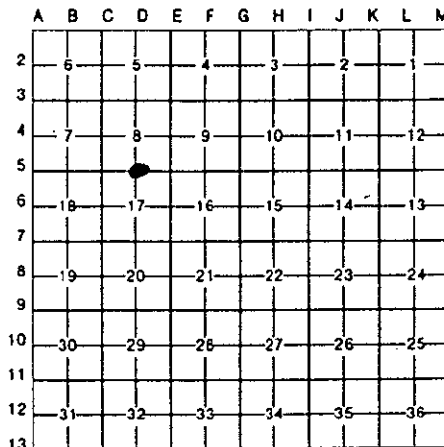

Randal D. Feenstra in a field survey on September 22, 1994

do hereby certify that under requirements of P.A. 74, Michigan P.A. of 1970, the corner points mentioned in lines 1 and 2 above were in conformance with regulations and rules therefore as required in the current manual of survey instructions of the United States Department of the Interior, Bureau of Land Management or by a decree of a Court of Law and/or that the corner points mentioned in lines 3, 4 and 5 above were in conformance with the rules of the Michigan Board of Land Surveyors or by a Decree of a Court of Law; established, re-established, monumented, re-monumented, recovered, found as expressed below:

NOTE: Not more than 4 corners, all in the same town and range, may be recorded on this certificate.

A. Description of original monument and accessories and/or subsequent restoration:

3.L.O. - June, 1837
By Rasselas Whitcomb

Liber 2, Page 820 - 5-1-75
By John Clapp

Liber 4, Page 225 10-13-81
By Thomas Joiner

POST
10" Beech S65°E 14 lks 36" Maple NE 38.80'
5" Beech N32°W 8 lks 30" Maple ENE 89.17'

C.I.M.
36" Maple NE 38.50'
36" Maple NNE 88.39'
Buried Cable Sign N 19.60'

3. Description of corner evidence found and/or method applied in restoring or reestablishing corner:

Found - C.I.M. - accepted as a careful and faithful perpetuation of the position of the original corner.
No Witnesses Found

Randal D. Feenstra
P.A. 345 OTTAWA COUNTY
PEER APPROVED 10/17/94

B. Description of monument for corner and accessories established to perpetuate locating the position of the corner:

D-5 Set O.C. Bar and Cap grouted into Monument Box over C.I.M.
Set O.C. Remon. Nail & tag in E side 16" W. Cherry N00°E 85.50'
Set O.C. Remon. Nail & tag in E end 15" culvert ADS-N-12 N50°E 39.58'
Set O.C. Remon. Nail & tag in W end 15" culvert ADS-N-12 S70°E 124.34'
Set O.C. Remon. Nail & tag in E side 12" Elm S10°W 46.39'
On CL Hoover Street

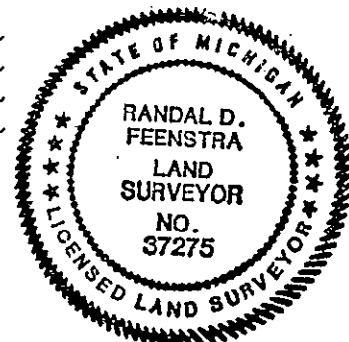

Signed by *Randal D. Feenstra*
Surveyor's Michigan License No. 37275

Date September 22, 1994