

SURVEY &  
REMONUMENTATION

FEB 18 1994

COMMISSION

For corners in

<u>Ottawa</u> (County)	Located In:	Corner Code ##
1. Public Land Survey	T 9N R 13W	D-7, S $\frac{1}{4}$ Cor
	T ___ R ___	Sec. 17, Chester
	T ___ R ___	_____
	T ___ R ___	_____
2. Property Controlling in Section	S ___ T ___ R ___	_____
	S ___ T ___ R ___	_____
3. Miscellaneous Property in Sec.	S ___ T ___ R ___	_____
	S ___ T ___ R ___	_____

RECORDED

93 NOV -8 PM 1:59

*D. J. ...*  
REGISTER OF DEEDS  
OTTAWA COUNTY, MI

Register of Deeds Stamp & File Number

4. Lot No. \_\_\_\_\_, Recorded Plat \_\_\_\_\_  
5. Private Claims \_\_\_\_\_

I, Randal D. Feenstra in a field survey on October 14, 19 93, do hereby certify that under requirements of P.A. 74, Michigan P.A. of 1970, the corner points mentioned in lines 1 and 2 above were in conformance with regulations and rules therefore as required in the current manual of survey instructions of the United States Department of the Interior, Bureau of Land Management or by a decree of a Court of Law and/or that the corner points mentioned in lines 3, 4 and 5 above were in conformance with the rules of the Michigan Board of Land Surveyors or by a Decree of a Court of Law; established, re-established, monumented, re-monumented, recovered, found as expressed below:

**NOTE: Not more than 4 corners, all in the same town and range, may be recorded on this certificate.**

	A	B	C	D	E	F	G	H	I	J	K	L	M
2	6	5	4	3	2	1							
3													
4	7	8	9	10	11	12							
5													
6	16	17	16	15	14	13							
7													
8	19	20	21	22	23	24							
9													
10	30	29	28	27	26	25							
11													
12	31	32	33	34	35	36							
13													

A. Description of original monument and accessories and/or subsequent restoration:

- D-7:  
L.C.R.C.# L-4, P-334 (9-22-82)  
Cast Iron Monument  
P.Pole S. 45.48'  
Underground Tele. sign NW 63.10'  
Fence Post SE 48.95'  
12" Conc. Culvert N. 23.02'

B. Description of corner evidence found and/or method applied in restoring or reestablishing corner:

- D-7: Found Cast Iron Monument - accepted as a careful and faithful perpetuation of the position of the original corner.  
Nail in N. side P.P. S0°E 45.45'

C. Description of monument for corner and accessories established to perpetuate locating the position of the corner:

- D-7: Cast Iron Monument  
O.C. Remon. Nail & Tag in W. side P.P. S0°E 45.94'  
O.C. Remon. Nail & Tag in top of fence post S50°E 48.96'  
"X" in W. side 12" conc. culvert N5°E 23.09'  
"X" in E. side 12" conc. culvert N30°E 29.94'

CL Gooding, fence line to South, brush line to North.

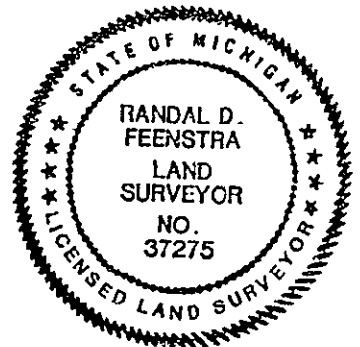

Signed by Randal D. Feenstra

Date 10-18-93

Surveyor's Michigan License No. 37275