

**SURVEY &  
REMONUMENTATION**

OCT 24 1994

COMMISSION

**OTTAWA COUNTY REMONUMENTATION  
LAND CORNER RECORDATION CERTIFICATE  
Filing Requirement of Act 74, Mich. P.A. 1970**

RECORDED

94 OCT -7 PM 12:34

For corners in

Ottawa (County)

Located In:

Corner Code #

- |                                    |                         |                  |
|------------------------------------|-------------------------|------------------|
| 1. Public Land Survey              | T 9N R 13W              | D-11, N 1/4 COR  |
|                                    | T _____ R _____         | Sec. 32, Chester |
|                                    | T _____ R _____         | _____            |
|                                    | T _____ R _____         | _____            |
| 2. Property Controlling in Section | S _____ T _____ R _____ | _____            |
|                                    | S _____ T _____ R _____ | _____            |
| 3. Miscellaneous Property in Sec.  | S _____ T _____ R _____ | _____            |
|                                    | S _____ T _____ R _____ | _____            |

*Rhonda Robinson*  
REGISTER OF DEEDS  
OTTAWA COUNTY, MI

Register of Deeds Stamp & File Number

4. Lot No. \_\_\_\_\_, Recorded Plat \_\_\_\_\_  
5. Private Claims \_\_\_\_\_

	A	B	C	D	E	F	G	H	I	J	K	L	M
2	6	5	4	3	2	1							
3													
4	7	8	9	10	11	12							
5													
6	18	17	16	15	14	13							
7													
8	19	20	21	22	23	24							
9													
10	30	29	28	27	26	25							
11													
12	31	32	33	34	35	36							
13													

Randal D. Feenstra, in a field survey on May 9, 1994, do hereby certify that under requirements of P.A. 74, Michigan P.A. of 1970, the corner points mentioned in lines 1 and 2 above were in conformance with regulations and rules therefore as required in the current manual of survey instructions of the United States Department of the Interior, Bureau of Land Management or by a decree of a Court of Law and/or that the corner points mentioned in lines 3, 4 and 5 above were in conformance with the rules of the Michigan Board of Land Surveyors or by a Decree of a Court of Law; established, re-established, monumented, re-monumented, recovered, found as expressed below:

**NOTE: Not more than 4 corners, all in the same town and range, may be recorded on this certificate.**

A. Description of original monument and accessories and/or subsequent restoration:

L.O. (1838) Liber 3, Page 16, (1975) Liber 5, Page 251 (1986)

- |                  |             |                        |                        |                        |
|------------------|-------------|------------------------|------------------------|------------------------|
| 1/2" Elm         | S20°E 17.8' | 3/4" Iron              | CIM                    |                        |
| 1/2" Maple       | N22°E 17.2' | Nail in PP             | ENE 95.30'             | Twin 3" Cherry N 71.11 |
| JST              |             | Top of iron fence post | S 36.90'               | PP ENE 95.54           |
| Asselas Whitcomb |             |                        | "X" in 12" Conc. Culv. | NNE 28.27              |
|                  |             |                        | "X" in 12" Conc. Culv. | NE 37.93               |

3. Description of corner evidence found and/or method applied in restoring or reestablishing corner:

Found: Cast Iron Mon. in Mon. Box - accepted as a careful and faithful perpetuation of the position of the original corner.

Found Witnesses:

- |                               |            |
|-------------------------------|------------|
| "X" in E side 12" conc. culv. | NE 37.92'  |
| "X" in W side 12" conc. culv. | NNE 28.26' |

P.A. 345 OTTAWA COUNTY

PEER APPROVED *9/22/94*

*Hordey V. Adewole*

C. Description of monument for corner and accessories established to perpetuate locating the position of the corner:

- |  |              |
|--|--------------|
| D-11 Cast Iron Mon. in Mon. Box  |              |
| Top Steel fence Post   | S55°E 60.10' |
| "X" in E side 12" conc. culv.  | N45°E 37.92' |
| "X" in W side 12" conc. culv.  | N15°E 28.26' |
| O.C. Remon. Nail & tag in SE side PP                                     | N55°E 93.94' |
| O.C. Remon. Nail & tag in W side 6" Twin Cherry                          | N10°W 70.98' |
| 0.5' N of CL Harding and 4' E of Tree line to N, 12' W of Tree line to S |              |

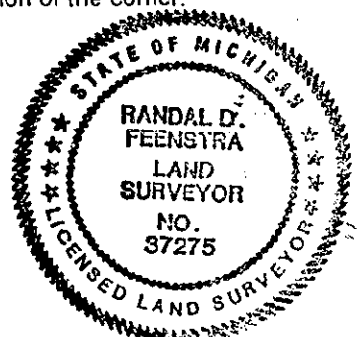

Signed by *Randal D. Feenstra*

Date May 9, 1994

Surveyor's Michigan License No. 37275