

**SURVEY & REMONUMENTATION**

OCT 24 1994

OTTAWA COUNTY REMONUMENTATION

RECORDED

COMMISSION

LAND CORNER RECORDATION CERTIFICATE  
 Filing Requirement of Act 74, Mich. P.A. 1970

*Deborah Kullman*  
 REGISTER OF DEEDS  
 OTTAWA COUNTY, MI

For corners in

Ottawa  
 (County)

Located In:

Corner Code #

- |                                    |                          |                  |
|------------------------------------|--------------------------|------------------|
| 1. Public Land Survey              | T <u>9N</u> R <u>13W</u> | D-13, S 1/4 COR  |
|                                    | T _____ R _____          | Sec. 32, Chester |
|                                    | T _____ R _____          | _____            |
|                                    | T _____ R _____          | _____            |
| 2. Property Controlling in Section | S _____ T _____ R _____  | _____            |
|                                    | S _____ T _____ R _____  | _____            |
| 3. Miscellaneous Property in Sec.  | S _____ T _____ R _____  | _____            |
|                                    | S _____ T _____ R _____  | _____            |

Register of Deeds Stamp & File Number

4. Lot No. \_\_\_\_\_, Recorded Plat \_\_\_\_\_
5. Private Claims \_\_\_\_\_

A	B	C	D	E	F	G	H	I	J	K	L	M
2	6	5	4	3	2	1						
3												
4	7	8	9	10	11	12						
5												
6	18	17	16	15	14	13						
7												
8	19	20	21	22	23	24						
9												
10	30	29	28	27	26	25						
11												
12	31	32	33	34	35	36						
13												

I, Randal D. Feenstra in a field survey on May 9, 19 94, do hereby certify that under requirements of P.A. 74, Michigan P.A. of 1970, the corner points mentioned in lines 1 and 2 above were in conformance with regulations and rules therefore as required in the current manual of survey instructions of the United States Department of the Interior, Bureau of Land Management or by a decree of a Court of Law and/or that the corner points mentioned in lines 3, 4 and 5 above were in conformance with the rules of the Michigan Board of Land Surveyors or by a Decree of a Court of Law; established, re-established, monumented, re-monumented, recovered, found as expressed below:

**NOTE: Not more than 4 corners, all in the same town and range, may be recorded on this certificate.**

A. Description of original monument and accessories and/or subsequent restoration:

<u>3.L.O. (1838)</u>	<u>Liber 3, Page 100 (1976)</u>	<u>Liber 4, Page 222 (1981)</u>
<u>Cor @ 8" Elm</u>	<u>5/8" Rod</u>	<u>CIM</u>
<u>Angelas Whitcomb</u>	<u>Crossbuck WNW 119.40</u>	<u>Crossbuck NWN 119.40</u>
	<u>NE end steel wingwall</u>	<u>NE End Stl. Wing Wall NE 48.30</u>
	<u>NE 48.30</u>	

B. Description of corner evidence found and/or method applied in restoring or reestablishing corner:

Found: Cast Iron Mon. - accepted as a careful and faithful perpetuation of the position of the original corner.

Found witnesses:

NE cor. steel headwall NE 49.55'±

P.A. 345 OTTAWA COUNTY

PEER APPROVED 9/22/94

*George P. Hedewell*

C. Description of monument for corner and accessories established to perpetuate locating the position of the corner:

- D-13 Cast Iron Monument
- O.C. Remon. Nail & tag in N side 8" Poplar S35°W 37.79'
- O.C. Remon. Nail & tag in N side 3" Box Elder S60°W 89.69'
- O.C. Remon. Nail & tag in SE side Fence Post N70°W 200.03'
- "X" in top of square headed bolt in top of 5" CSP N65°E 48.85'
- Wright Township Corner N90°E 70.19'
- on CL Wilson.

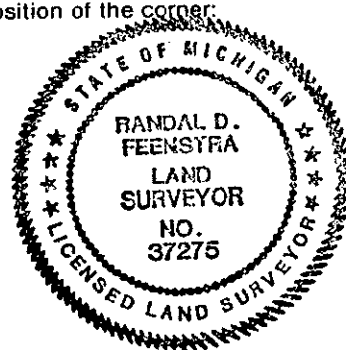

Signed by Randal D. Feenstra

Date May 9, 1994

Surveyor's Michigan License No. 37275