

SURVEY &
REMONUMENTATION

FEB 18 1994

OTTAWA COUNTY REMONUMENTATION
LAND CORNER RECORDATION CERTIFICATE
Filing Requirement of Act 74, Mich. P.A. 1970

RECORDED

93 NOV -8 PM 1:59

Phyllis Chalkman
REGISTER OF DEEDS
OTTAWA COUNTY, MI

For corners in **COMMISSION**

<u>Ottawa</u> (County)	Located In:	Corner Code #
1. Public Land Survey	T <u>9N</u> R <u>13W</u>	<u>E-5, NE COR.</u> <u>Sec. 17, Chester</u>
	T _____ R _____	_____
	T _____ R _____	_____
	T _____ R _____	_____
2. Property Controlling in Section	S _____ T _____ R _____	_____
	S _____ T _____ R _____	_____
3. Miscellaneous Property in Sec.	S _____ T _____ R _____	_____
	S _____ T _____ R _____	_____
4. Lot No. _____, Recorded Plat _____		
5. Private Claims _____		

Register of Deeds Stamp & File Number

I, Randal D. Feenstra in a field survey on October 14, 19 93, do hereby certify that under requirements of P.A. 74, Michigan P.A. of 1970, the corner points mentioned in lines 1 and 2 above were in conformance with regulations and rules therefore as required in the current manual of survey instructions of the United States Department of the Interior, Bureau of Land Management or by a decree of a Court of Law and/or that the corner points mentioned in lines 3, 4 and 5 above were in conformance with the rules of the Michigan Board of Land Surveyors or by a Decree of a Court of Law; established, re-established, monumented, re-monumented, recovered, found as expressed below:

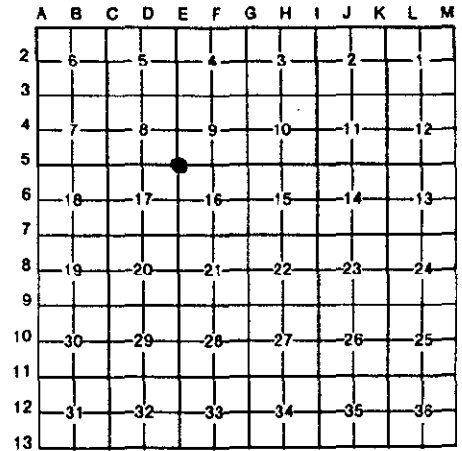

NOTE: Not more than 4 corners, all in the same town and range, may be recorded on this certificate.

A. Description of original monument and accessories and/or subsequent restoration:

L.C.R.C.# L-2, P-69 (2-15-73)	L.C.R.C.# L-2, P-103 (4-12-73)	L.C.R.C.# L-6, P-120 (10-30-90)
3/4" Pipe	3/4" Pipe	Cast Iron Monument
Street sign SE 44.78'	Street sign SE 44.78	40" Maple WSW 53.15'
40" Maple SW 53.15'	40" Maple SW 53.15	CL Tele. Ped. NW 52.20'
Telephone Pedestal NW 52.84'	Telephone Pedestal NW 52.84	CL Street Sign NE 42.80'
		CL S. Leg of Sign SE 50.88'

B. Description of corner evidence found and/or method applied in restoring or reestablishing corner:

E-5: Found Cast Iron Monument in Box - accepted as a careful and faithful perpetuation of the position of the original corner.

PK in N. side 40" Maple	S70°W	52.51'
Nail in S. side 40" Maple	S70°W	53.17'
CL Telephone Pedestal	N50°W	51.85'
CL W. leg of sign	S60°E	50.94'

C. Description of monument for corner and accessories established to perpetuate locating the position of the corner:

E-5: Cast Iron Monument in Box

O.C. Remon. Nail & Tag in N. side 40" Maple	S70°W	52.53'
O.C. Remon. Nail & Tag in N. side 36" Maple	S80°W	73.70'
CL Telephone Pedestal	N50°W	51.85'
"X" in E. side CSP culvert	S40°E	56.05'

CL "X" 32nd Ave. & Hoover St. (East), 7' S. of Hoover St. (West)

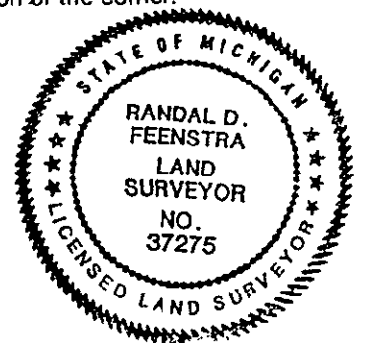

Signed by *Randal D. Feenstra* Date 10-18-93
Surveyor's Michigan License No. 37275