

**SURVEY &
REMONUMENTATION**

OCT 24 1994

COMMISSION

**OTTAWA COUNTY REMONUMENTATION
LAND CORNER RECORDATION CERTIFICATE
Filing Requirement of Act 74, Mich. P.A. 1970**

RECORDED

94 OCT -7 PM 12:34

Reginald C. Hollman
REGISTER OF DEEDS
OTTAWA COUNTY, MI

For corners in

Ottawa

(County)

Located In:

Corner Code ##

- | | | | | | |
|---------------------------------------|---|----|---|-----|----------------------------------|
| 1. Public Land Survey | T | 9N | R | 13W | E-9, SE COR.
Sec. 20, Chester |
| | T | | R | | |
| | T | | R | | |
| | T | | R | | |
| 2. Property Controlling
in Section | S | | T | R | |
| | S | | T | R | |
| 3. Miscellaneous
Property in Sec. | S | | T | R | |
| | S | | T | R | |

Register of Deeds Stamp & File Number

4. Lot No. _____, Recorded Plat _____
5. Private Claims _____

I, Randal D. Feenstra in a field survey on April 28, 19 94, do hereby certify that under requirements of P.A. 74, Michigan P.A. of 1970, the corner points mentioned in lines 1 and 2 above were in conformance with regulations and rules therefore as required in the current manual of survey instructions of the United States Department of the Interior, Bureau of Land Management or by a decree of a Court of Law and/or that the corner points mentioned in lines 3, 4 and 5 above were in conformance with the rules of the Michigan Board of Land Surveyors or by a Decree of a Court of Law; established, re-established, monumented, re-monumented, recovered, found as expressed below:

NOTE: Not more than 4 corners, all in the same town and range, may be recorded on this certificate.

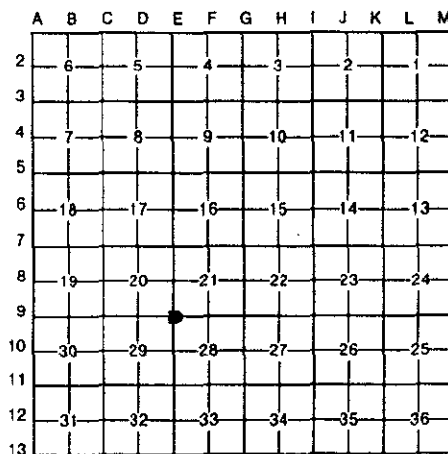

A. Description of original monument and accessories and/or subsequent restoration:
L.O. (1838) Liber 5, Page 5 (1982) Liber 5, Page 104 (1984)

3" Ash	S79°E 9.9'	CAST IRON MONUMENT	1/2" Rod in Mon. Box
5" Ironwood	N59°W 7.9'	Power Pole SSW 102.25	Nail in NW side 12" Hickory ENE 61.43
OST		17" Hickory ENE 61.45	Nail in E side P.Pole SSW 102.20
Asselas Whitcomb		Fence Post SW 38.33	Pk. in NW side fence post SW 38.33
		St. Sign NW 43.70	

Liber 6, Page 220 (1992) - CIM in Mon. Box; Nail in W side PP N10°W 175.92; Nail in SE side 8" Ash N40°E 77.76; Nail in SE side 8" Cherry N65°E 92.68; Nail in E side PP S15°W 102.22; Pk. in NW side Fence Post S55°W 30.28

B. Description of corner evidence found and/or method applied in restoring or reestablishing corner:

Found: Cast iron monument in monument box (no cover) - accepted as a careful and faithful perpetuation of the position of the original corner.

Found Witnesses:

Nail in SE side 8" Ash	NE 77.91'
Nail in SE side 12" Cherry	ENE 92.86'
Nail in E side PP	SW 102.18'
Nail in W side PP	NNW 175.97'

RA. 945 OTTAWA COUNTY

DEED APPROVED 9/22/94

Randal D. Feenstra

C. Description of monument for corner and accessories established to perpetuate locating the position of the corner:

E-9 - Cast Iron Monument in Monument box (No Cover)		
O.C. Remon. Nail & Tag in NW side PP	S20°W	102.05'
O.C. Remon. Nail & Tag in NW side 8" Ash	N45°E	77.75'
O.C. Remon. Nail & Tag in NW side 12" Cherry	N60°E	92.38'
O.C. Remon. Nail & tag in E side PP	N20°W	175.95'
On CL "x" 32nd Avenue and Coolidge Street		

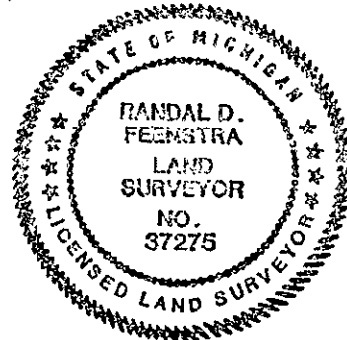

Signed by Randal D. Feenstra

Date April 28, 1994

Surveyor's Michigan License No. 37275