

SURVEY & REMONUMENTATION

OCT 24 1994

COMMISSION

**OTTAWA COUNTY REMONUMENTATION
LAND CORNER RECORDATION CERTIFICATE
Filing Requirement of Act 74, Mich. P.A. 1970**

RECORDED

94 OCT -7 PM 12:34

Phyllis Callman
REGISTER OF DEEDS
OTTAWA COUNTY, MI

For corners in
Ottawa
(County)

Located In:

Corner Code #

- | | | | | | |
|------------------------------------|---|----|---|-----|------------------|
| 1. Public Land Survey | T | 9M | R | 13W | F-11, N 1/4 COR |
| | T | | R | | Sec. 33, Chester |
| | T | | R | | |
| | T | | R | | |
| 2. Property Controlling in Section | S | | T | R | |
| | S | | T | R | |
| 3. Miscellaneous Property in Sec. | S | | T | R | |
| | S | | T | R | |

Register of Deeds Stamp & File Number

4. Lot No. _____, Recorded Plat _____
5. Private Claims _____

	A	B	C	D	E	F	G	H	I	J	K	L	M
2	6		5		4		3		2		1		
3													
4	7		8		9		10		11		12		
5													
6	18		17		16		15		14		13		
7													
8	19		20		21		22		23		24		
9													
10	30		29		28		27		26		25		
11													
12	31		32		33		34		35		36		
13													

I, Randal D. Feenstra a field survey on May 9, 19 94, do hereby certify that under requirements of P.A. 74, Michigan P.A. of 1970, the corner points mentioned in lines 1 and 2 above were in conformance with regulations and rules therefore as required in the current manual of survey instructions of the United States Department of the Interior, Bureau of Land Management or by a decree of a Court of Law and/or that the corner points mentioned in lines 3, 4 and 5 above were in conformance with the rules of the Michigan Board of Land Surveyors or by a Decree of a Court of Law; established, re-established, monumented, re-monumented, recovered, found as expressed below:

NOTE: Not more than 4 corners, all in the same town and range, may be recorded on this certificate.

A. Description of original monument and accessories and/or subsequent restoration:

G.L.O. (1838)	Liber 1, Page 621 (1972)	Liber 5, Page 251 (1986)
5" Beech S33°W 10.6'	3/4" Rod in Mon. Box	C.I.M.
8" Tree N25°E 7.9'	18" W. Cherry NNE 26.63	B. Cherry NNE 26.38
POST	4" Walnut SW 38.57	6" Apple Tree SSE 71.21
Rasselas Whitcomb		6" Apple Tree SE 60.40
		6" Apple Tree ESE 89.79

B. Description of corner evidence found and/or method applied in restoring or reestablishing corner:

Found: Cast Iron Mon. in Mon. Box - accepted as a careful and faithful perpetuation of the position of the original corner.

Found Witnesses:

Nail & tag in W side 8" Apple	SE 89.79'
Nail & tag in W side 8" Apple	SSE 71.23'
Nail & tag in W side 20" Cherry	N 26.48'

C. Description of monument for corner and accessories established to perpetuate locating the position of the corner:

F-11 Cast Iron Mon. in Mon. Box (Box 0.5' below B.T.)	
O.C. Remon. Nail & tag in W side 20" Cherry	N10°E 26.22'
O.C. Remon. Nail & tag in N side PP	S60°W 74.24'
"X" in W end 12" conc. culv.	S00°E 22.15'
"X" in E end 12" conc. culv.	S50°E 37.49'
1.5' N of CL Harding Street and Treeline to N	

P.A. 345 OTTAWA COUNTY
PEER APPROVED 02/24
Robert P. Medwell

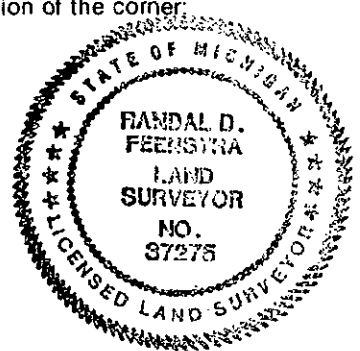

Signed by Randal D. Feenstra Date May 9, 1994

Surveyor's Michigan License No. 37275