

OTTAWA COUNTY REMONUMENTATION

RECORDED

LAND CORNER RECORDATION CERTIFICATE
Filing Requirement of Act 74, Mich. P.A. 1970

97 JUL 24 PM 2: 25

For corners in
Ottawa

Randal D. Feenstra
REGISTER OF DEEDS
OTTAWA COUNTY, MI

(County)	Located In:	Corner Code #
	Chester Twp.	
1. Public Land Survey	T <u>9</u> N R <u>13</u> W	G-1, NW cor. Sec. 3
	T ___ R ___	_____
	T ___ R ___	_____
	T ___ R ___	_____
2. Property Controlling in Section	S ___ T ___ R ___	_____
	S ___ T ___ R ___	_____
3. Miscellaneous Property in Sec.	S ___ T ___ R ___	_____
	S ___ T ___ R ___	_____

Register of Deeds Stamp & File Number

4. Lot No. _____, Recorded Plat _____
5. Private Claims _____

I, Randal D. Feenstra, in a field survey on Oct. 5, 1996 do hereby state that under requirements of P.A. 74, Michigan P.A. of 1970, the corner points mentioned in lines 1 and 2 above were in conformance with regulations and rules therefore as required in the current manual of survey instructions of the United States Department of the Interior, Bureau of Land Management or by a decree of a Court of Law and /or that the corner points mentioned in lines 3, 4 and 5 above were in conformance with the rules of the Michigan Board of Land Surveyors or by a Decree of a Court of Law; established, re-established, monumented, recovered, found as expressed below:

	A	B	C	D	E	F	G	H	I	J	K	L	M
1													
2	6	5	4	3	2	1							
3													
4	7	8	9	10	11	12							
5													
6	18	17	16	15	14	13							
7													
8	19	20	21	22	23	24							
9													
10	30	29	28	27	26	25							
11													
12	31	32	33	34	35	36							
13													

NOTE: Not more than 2 corners, all in the same town and range, may be recorded on this certificate.

A. Description of original monument and accessories and/or subsequent restoration:

G.L.O. (1837)	L-5, P-359, (1988)		
Noah Brookfield	Rerod and Cap		
Post	Nail in SE side L.P.	S50°W	32.65'
12" Pine	CL 2" Pipe	N5°W	36.70'
12" Pine	CL Top W edge 12" culvert	S75°E	103.45'

P.A. 345 OTTAWA COUNTY
PEER APPROVED 12-9-96

R.D.F.

B. Description of corner evidence found and/or method applied in restoring or reestablishing corner:

G-1 Found: 1/2" Rerod in BT

Nail in E. side L.P. S50°W 32.40'
CL 2" Pipe N5°W 36.70'
Top W. Edge 12" CMP S75°E 103.45'



Accepted as a careful and faithful perpetuation of the position of the original corner.

C. Description of monument for corner and accessories established to perpetuate locating the position of the corner:

G-1: Replaced 1/2" rerod with Ottawa County Remon Bar and Cap in new Monument Box--falls on townline
Muskegon County Corner - RR spike @ CL Canada & Sherman Rds. WEST 38.94' (SEE SKETCH ON BACK)
West end 12" CMP S 75°E 103.45'
Ottawa County Remon Nail & Tag in N. Side of Light Pole N 49°W 32.75'
Ottawa County Remon Nail & Tag in W Side of 14" Willow N 28°W 356.98'
Ottawa County Remon Nail & Tag in top of 4" Fence Post North 174.96'
CL 2" Pipe for Sign Post (Sherman and 24th) S 40°E 65.75'
CL Sign Post (Sherman and Canada) N 5°W 37.90'
CL 24th Ave to South - 17.60' EAST

11.00 CORNER

Signed by Randal D. Feenstra
Surveyor's Michigan License No. 37275

Date October 10, 1996

MUSKEGON COUNTY
CASNOVIA TWP.

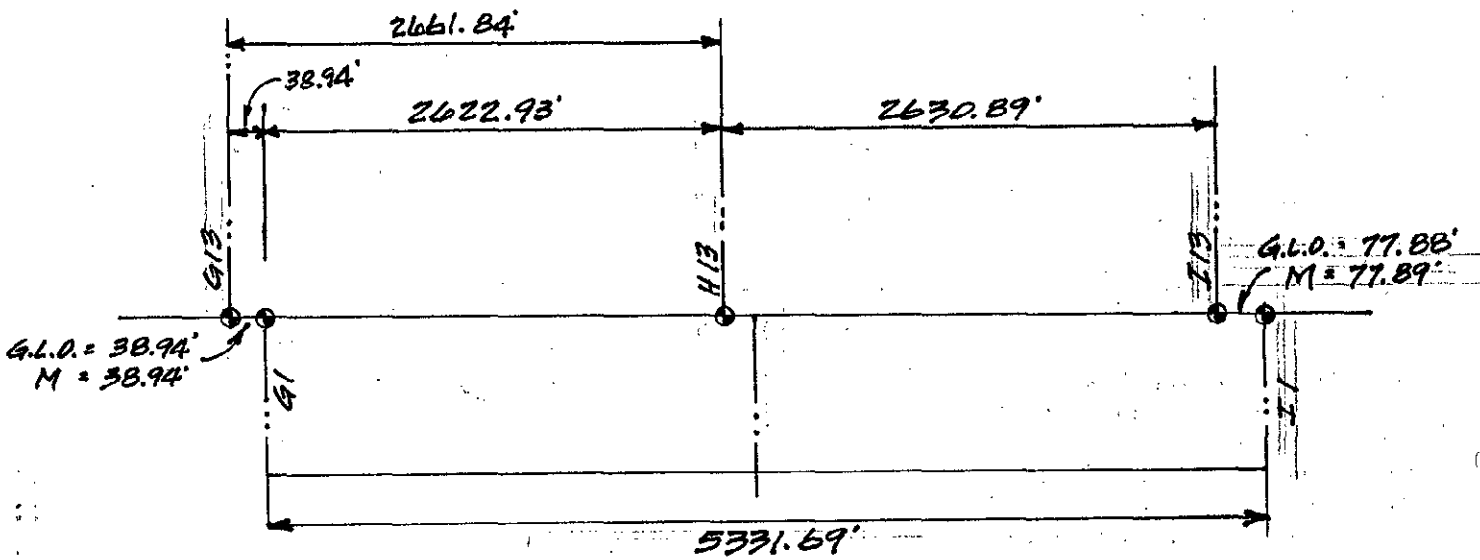

OTTAWA COUNTY
CHESTER TOWNSHIP