

SURVEY & REMONUMENTATION

APR 24 1995

COMMISSION

For corners in
Ottawa
(County)

**OTTAWA COUNTY REMONUMENTATION
LAND CORNER RECORDATION CERTIFICATE
Filing Requirement of Act 74, Mich. P.A. 1970**

RECORDED

94 DEC 15 AM 11:47

Regina A. Chittman
REGISTER OF DEEDS
OTTAWA COUNTY, MI

Located In:	Corner Code --#
1. Public Land Survey	T 9N R 13W G-3, NE Cor. Sec. 9 Chester Twp.
2. Property Controlling in Section	S T R
3. Miscellaneous Property in Sec.	S T R

Register of Deeds Stamp & File Number

4. Lot No. _____, Recorded Plat _____
5. Private Claims _____

	A	B	C	D	E	F	G	H	I	J	K	L	M
2	6	5	4	3	2	1							
3													
4	7	8	9	10	11	12							
5													
6	18	17	16	15	14	13							
7													
8	19	20	21	22	23	24							
9													
10	30	29	28	27	26	25							
11													
12	31	32	33	34	35	36							
13													

I, Randal D. Feenstra, in a field survey on December 8, 1994, do hereby certify that under requirements of P.A. 74, Michigan P.A. of 1970, the corner points mentioned in lines 1 and 2 above were in conformance with regulations and rules therefore as required in the current manual of survey instructions of the United States Department of the Interior, Bureau of Land Management or by a decree of a Court of Law and/or that the corner points mentioned in lines 3, 4 and 5 above were in conformance with the rules of the Michigan Board of Land Surveyors or by a Decree of a Court of Law; established, re-established, monumented, re-monumented, recovered, found as expressed below:

NOTE: Not more than 4 corners, all in the same town and range, may be recorded on this certificate.

A. Description of original monument and accessories and/or subsequent restoration:

G.L.O. by Rasselas Whitcomb Sept. 17, 1838 POST 12" Sugar N31 W 34 links 36" Beech S 65 E 17 links	L-2, P-119 (1973) 3/4" Pipe in mon. box Guy Pole NW 61.13 Guard Post NE 40.15 St. Sign SE 48.88	L-5, P-50 (1983) C.I.M. P.P. NW 64.33 T. Ped. SW 53.12 1" Spruce NE 61.75 St. sign SE 48.70'	L-5, P-272, 1987 C.I.M. P. Pole NW 64.32' T. Pole SW 52.92' St. Sign SE 48.75' 1" Spruce NE 61.80' S Cor. Brick Hse NE 153.24'
--	---	---	---

B. Description of corner evidence found and/or method applied in restoring or reestablishing corner:

Found: C.I.M. in box and is accepted as a careful and faithful perpetuation of the position of the original corner.

Found Witnesses:
Pk in E side P. Pole NW 64.35'
CL T. Pod. SW 52.93'
S Cor. Brick Hse NE 153.26'

P.A. 345 OTTAWA COUNTY
PEER APPROVED 12/12/94
Wendy D. Redwood

C. Description of monument for corner and accessories established to perpetuate locating the position of the corner:

G-3 C.I.M. in Box
O.C. Remon Nail & Tag in E side P. Pole N40 W 64.40'
"X" in E end 12" Conc. Culv. N30 E 46.09'
"X" in W end 12" Conc. Culv. S55 E 46.87'
O.C. Remon Nail & Tag in E side 6" Maple N25 W 99.46'
On CL "X" Truman Street and 24th Avenue

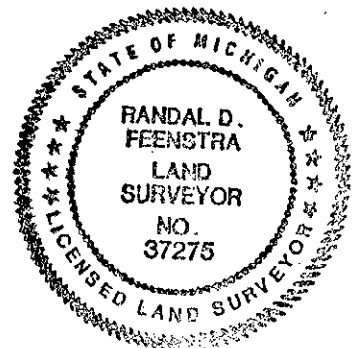

Signed by Randal D. Feenstra Date December 8, 1994
Surveyor's Michigan License No. 37275