

SURVEY & REMONUMENTATION

APR 24 1995

COMMISSION

For corners in

Ottawa

(County)

OTTAWA COUNTY REMONUMENTATION LAND CORNER RECORDATION CERTIFICATE Filing Requirement of Act 74, Mich. P.A. 1970

RECORDED

94 DEC 15 AM 11:48

Dyckie Kallman
REGISTER OF DEEDS
OTTAWA COUNTY, MI

Located In:	Corner Code #
1. Public Land Survey T <u>9N</u> R <u>13W</u>	G-4, E 1/4 Cor.
T _____ R _____	Sec. 9
T _____ R _____	Chester Twp.
T _____ R _____	
2. Property Controlling S _____ T _____ R _____	
in Section S _____ T _____ R _____	
3. Miscellaneous S _____ T _____ R _____	
Property in Sec. S _____ T _____ R _____	

Register of Deeds Stamp & File Number

4. Lot No. _____, Recorded Plat _____
5. Private Claims _____

	A	B	C	D	E	F	G	H	I	J	K	L	M
2	6		5		4		3		2		1		
3													
4	7		8		9		10		11		12		
5													
6	18		17		16		15		14		13		
7													
8	19		20		21		22		23		24		
9													
10	30		29		28		27		26		25		
11													
12	31		32		33		34		35		36		
13													

I, Randal D. Feenstra, in a field survey on December 8, 1994, do hereby certify that under requirements of P.A. 74, Michigan P.A. of 1970, the corner points mentioned in lines 1 and 2 above were in conformance with regulations and rules therefore as required in the current manual of survey instructions of the United States Department of the Interior, Bureau of Land Management or by a decree of a Court of Law and/or that the corner points mentioned in lines 3, 4 and 5 above were in conformance with the rules of the Michigan Board of Land Surveyors or by a Decree of a Court of Law; established, re-established, monumented, re-monumented, recovered, found as expressed below:

NOTE: Not more than 4 corners, all in the same town and range, may be recorded on this certificate.

A. Description of original monument and accessories and/or subsequent restoration:

G.L.O. by Rasselas Whitcomb	L-2, P-119 (1973)	L-6, P-121 (1991)
Sept. 17, 1838	R.R. Spike	C.I.M.
POST	Pine SE 70.22	SW Cor. Hse. SE 70.95'
12" Sugar N63 E 24 links	22" Ash - NE 59.10	NW Cor. Hse. E 63.25'
10" Beech S86 W 17 links	NW Cor. Hse E 63.08'	22" Ash NE 59.10'
		10" Elm WSW 31.76'

B. Description of corner evidence found and/or method applied in restoring or reestablishing corner:

Found: C.I.M. in box and is accepted as a careful and faithful perpetuation of the position of the original corner.

Nail in N side 10" Elm	WSW 31.79'
Nail in NW side 28" Ash	NE 59.11'
SW Cor. Hse	SE 70.91'
NW Cor. Hse	E 63.20'

P.A. 345 OTTAWA COUNTY
PEER APPROVED 12/12/94
Conroy D. Medewald

C. Description of monument for corner and accessories established to perpetuate locating the position of the corner:

G-4 C.I.M. in Box	
O.C. Remon. Nail & Tag in W side 18" W Pine	S30 E 69.99'
O.C. Remon. Nail & Tag in NW side 28" Ash	N30 E 59.12'
O.C. Remon Nail & Tag in N side 10" Elm	S80 W 31.75'
O.C. Remon. Nail & Tag in S side 12" Ash	N45 W 40.94'
On CL 24th Avenue	

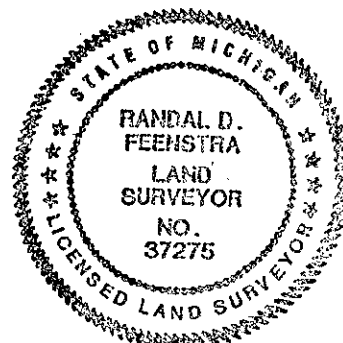

Signed by *Randal D. Feenstra*

Date December 8, 1994

Surveyor's Michigan License No. 37275