

# SURVEY & REMONUMENTATION

APR 24 1995

## OTTAWA COUNTY REMONUMENTATION LAND CORNER RECORDATION CERTIFICATE Filing Requirement of Act 74, Mich. P.A. 1970

RECORDED

94 DEC 15 AM 11:47

For corners in **COMMISSION**

*Johnnie Redmond*  
REGISTER OF DEEDS  
OTTAWA COUNTY, MI

For corners in Ottawa (County)	Located In:	Corner Code #
1. Public Land Survey	T <u>9N</u> R <u>13W</u>	<u>G-5, SE Cor.</u>
	T _____ R _____	<u>Sec. 9</u>
	T _____ R _____	<u>Chester Twp.</u>
	T _____ R _____	_____
2. Property Controlling in Section	S _____ T _____ R _____	_____
	S _____ T _____ R _____	_____
3. Miscellaneous Property in Sec.	S _____ T _____ R _____	_____
	S _____ T _____ R _____	_____

Register of Deeds Stamp & File Number

4. Lot No. \_\_\_\_\_, Recorded Plat \_\_\_\_\_  
5. Private Claims \_\_\_\_\_

I, Randal D. Feenstra, in a field survey on December 8, 1994, do hereby certify that under requirements of P.A. 74, Michigan P.A. of 1970, the corner points mentioned in lines 1 and 2 above were in conformance with regulations and rules therefore as required in the current manual of survey instructions of the United States Department of the Interior, Bureau of Land Management or by a decree of a Court of Law and/or that the corner points mentioned in lines 3, 4 and 5 above were in conformance with the rules of the Michigan Board of Land Surveyors or by a Decree of a Court of Law; established, re-established, monumented, re-monumented, recovered, found as expressed below:

	A	B	C	D	E	F	G	H	I	J	K	L	M
2	6	5	4	3	2	1							
3													
4	7	8	9	10	11	12							
5													
6	18	17	16	15	14	13							
7													
8	19	20	21	22	23	24							
9													
10	30	29	28	27	26	25							
11													
12	31	32	33	34	35	36							
13													

**NOTE: Not more than 4 corners, all in the same town and range, may be recorded on this certificate.**

A. Description of original monument and accessories and/or subsequent restoration:

G.L.O. by Rasselas Whitcomb	L-1, P-131 (1971)	L-2, P-119 (1973)	L-5, P-49 (1983)
Sept. 17, 1838	16" Cherry NW 84.94	SPIKE	C.I.M.
POST	P.P. SE 93.11'	T.Pole NE 45.40'	18" Cherry WNW 94.58'
14" Beech N74 E 19 links	T.Pole NE 94.96'	P.P. ESE 93.45'	T.Pole NE 45.39'
12" Beech S88 W 23 links	SE Cor. Hsc NW 123.87'	18" Cherry WNW 86.20'	P. Pole ESE 93.40'
			11" Poplar SSE 101.47'

B. Description of corner evidence found and/or method applied in restoring or reestablishing corner:  
Found: C.I.M. in box and is accepted as a careful and faithful perpetuation of the position of the original corner.

Nail in S side 25" Cherry WNW 94.67'  
Pk in NW side T. Pole NE 45.41'  
Pk in N side P. Pole ESE 93.42'  
Nail & tag in W side 14" Poplar SSE 101.45'

PA. 345 OTTAWA COUNTY  
PEER APPROVED 12/12/94  
*Harvey D. Nedewold*

C. Description of monument for corner and accessories established to perpetuate locating the position of the corner:

G-5 C.I.M. in Box	
O.C. Remon. Nail & Tag in S side 25" Cherry	N65 W 94.62'
O.C. Remon Nail & Tag in NW side T.Pole	N45 E 45.44'
O.C. Remon Nail & Tag in N side P. Pole	S65 E 93.39'
O.C. Remon Nail & Tag in N side Poplar	S30 E 101.40'

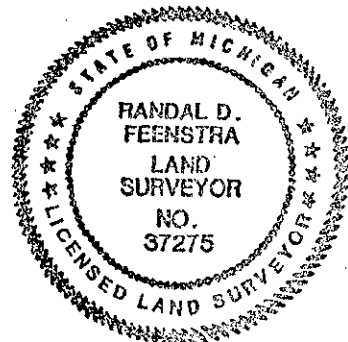

Signed by *Randal D. Feenstra*

Date December 8, 1994

Surveyor's Michigan License No. 37275