

OCT 24 1994

COMMISSION

OTTAWA COUNTY REMONUMENTATION

LAND CORNER RECORDATION CERTIFICATE
Filing Requirement of Act 74, Mich. P.A. 1970

RECORDED

94 OCT -7 PM 12:34

Deborah Lindeman
REGISTER OF DEEDS
OTTAWA COUNTY, MI

For corners in
Ottawa
(County)

Located In:

Corner Code #

- | | | |
|---------------------------------------|-------------------------|------------------|
| 1. Public Land Survey | T 9N R 13W | G-11, NE COR |
| | T _____ R _____ | Sec. 33, Chester |
| | T _____ R _____ | _____ |
| | T _____ R _____ | _____ |
| 2. Property Controlling in Section | S _____ T _____ R _____ | _____ |
| | S _____ T _____ R _____ | _____ |
| 3. Miscellaneous Property in Sec. | S _____ T _____ R _____ | _____ |
| | S _____ T _____ R _____ | _____ |
| 4. Lot No. _____, Recorded Plat _____ | | |
| 5. Private Claims _____ | | |

Register of Deeds Stamp & File Number

I, Randal D. Feenstra in a field survey on May 9, 19 94, do hereby certify that under requirements of P.A. 74, Michigan P.A. of 1970, the corner points mentioned in lines 1 and 2 above were in conformance with regulations and rules therefore as required in the current manual of survey instructions of the United States Department of the Interior, Bureau of Land Management or by a decree of a Court of Law and/or that the corner points mentioned in lines 3, 4 and 5 above were in conformance with the rules of the Michigan Board of Land Surveyors or by a Decree of a Court of Law; established, re-established, monumented, re-monumented, recovered, found as expressed below:

NOTE: Not more than 4 corners, all in the same town and range, may be recorded on this certificate.

A	B	C	D	E	F	G	H	I	J	K	L	M
2	6	5	4	3	2	1						
3												
4	7	8	9	10	11	12						
5												
6	18	17	16	15	14	13						
7												
8	19	20	21	22	23	24						
9												
10	30	29	28	27	26	25						
11												
12	31	32	33	34	35	36						
13												

A. Description of original monument and accessories and/or subsequent restoration:

G.L.O. (1838) Liber 6, Page 117 (1990)

24" Elm N14°W 7.9'	CIM	
15" Elm S39°E 8.6'	PP	SE 65.22
POST	PP	SE 58.56
Rasselas Whitcomb	Tel Ped.	NW 51.94
	PP	NE 160.79

B. Description of corner evidence found and/or method applied in restoring or reestablishing corner:

Found: Cast Iron Mon. in Mon. Box - accepted as a careful and faithful perpetuation of the position of the original corner.

Found Witnesses:

CL W'ly Telephone Ped.	NW 51.78'
Nail in NE side PP	SE 65.21'
Nail in SE side PP	SW 58.53'

C. Description of monument for corner and accessories established to perpetuate locating the position of the corner:

G-11 Cast Iron Mon. in Mon. Box	
O.C. Remon. Nail & tag in SW side PP	S50°E 64.95'
O.C. Remon. Nail & tag in SE side PP	S45°W 58.44'
"X" in E side 12" conc. culv.	N45°E 43.81'
"X" in W side 12" conc. culv.	N45°W 43.91'
3.5' S and 2.5' E of CL "X" 24th Avenue and Harding Street.	

PA. 345 OTTAWA COUNTY
PEER APPROVED *01/22/94*

Robert P. Hedewell

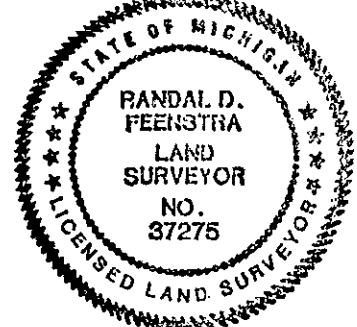

Signed by Randal D. Feenstra

Date May 9, 1994

Surveyor's Michigan License No. 37275