

SURVEY & REMONUMENTATION

OCT 24 1994

COMMISSION

OTTAWA COUNTY REMONUMENTATION

RECORDED

LAND CORNER RECORDATION CERTIFICATE
Filing Requirement of Act 74, Mich. P.A. 1970

OCT -7 PM 12:34

For corners in

<u>Ottawa</u> (County)	Located In:	Corner Code #
1. Public Land Survey	T 9N R 13W	G-13, SE COR
	T _____ R _____	Sec. 33, Chester
	T _____ R _____	
	T _____ R _____	
2. Property Controlling in Section	S _____ T _____ R _____	
	S _____ T _____ R _____	
3. Miscellaneous Property in Sec.	S _____ T _____ R _____	
	S _____ T _____ R _____	
4. Lot No. _____, Recorded Plat _____		
5. Private Claims _____		

D. J. ...
REGISTER OF DEEDS
OTTAWA COUNTY, MI

Register of Deeds Stamp & File Number

I, Randal D. Feenstra in a field survey on May 9, 19 94, do hereby certify that under requirements of P.A. 74, Michigan P.A. of 1970, the corner points mentioned in lines 1 and 2 above were in conformance with regulations and rules therefore as required in the current manual of survey instructions of the United States Department of the Interior, Bureau of Land Management or by a decree of a Court of Law and/or that the corner points mentioned in lines 3, 4 and 5 above were in conformance with the rules of the Michigan Board of Land Surveyors or by a Decree of a Court of Law; established, re-established, monumented, re-monumented, recovered, found as expressed below:

NOTE: Not more than 4 corners, all in the same town and range, may be recorded on this certificate.

	A	B	C	D	E	F	G	H	I	J	K	L	M
2	6	5	4	3	2	1							
3													
4	7	8	9	10	11	12							
5													
6	13	17	16	15	14	13							
7													
8	19	20	21	22	23	24							
9													
10	30	29	28	27	26	25							
11													
12	31	32	33	34	35	36							
13													

A. Description of original monument and accessories and/or subsequent restoration:

L.O. (1838)	Liber 5, Page 6 (1982)		
0" Beech	N77°E 22.4'	CIM	
" Ironwood	N77°W 36.3'	PP	NE 42.00
JST		30" Maple	SSE 81.30
Asselas Whitcomb		PP	WSW 142.65
		TP	NW 55.45
		Wire Con.	E 35.1
		Tele Ped.	SE 89.00
		CL ROW Marker	NE 65.05

B. Description of corner evidence found and/or method applied in restoring or reestablishing corner:

Found: Cast Iron Mon. in Mon. Box - accepted as a careful and faithful perpetuation of the position of the original corner.

Found Witnesses:

NE 1/4, COR, SE. 4, T8N, R13W	E 33.28'
CL ROW Marker	NE 65.00'
CL Tele. Ped.	SE 88.95'

P.A. 345 OTTAWA COUNTY
PEER APPROVED 8/22/94

Gordon D. Tidwell

C. Description of monument for corner and accessories established to perpetuate locating the position of the corner:

G-13 Cast Iron Mon. in Mon. Box		
O.C. Remon. Nail & tag in W side PP	S60°E	158.72'
O.C. Remon. Nail & tag in E side PP	N60°E	70.48'
O.C. Remon. Nail & tag in top of guard rail post	S65°W	36.99'
Wright Township Corner	N90°E	33.28'
On CL Wilson and 3'E of CL 24th to N.		

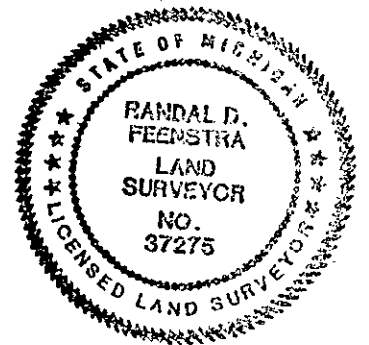

Signed by Randal D. Feenstra

Date May 9, 1994

Surveyor's Michigan License No. 37275