

SURVEY & REMONUMENTATION

JUN 28 1999

SECTION

**OTTAWA COUNTY REMONUMENTATION
LAND CORNER RECORDATION CERTIFICATE**
Filing Requirement of Act 74, Mich. P.A. 1970

RECORDED

98 NOV -4 PM 2:32

Randy Schultz
REGISTER OF DEEDS
OTTAWA COUNTY, MI

For corners in Ottawa	Located in:	Corner Code #
(County)	Chester Twp.	
	9N 13W	H-1
1. Public Land Survey	T___ R___	N 1/4 Cor., Sec. 3
	T___ R___	_____
	T___ R___	_____
	T___ R___	_____
2. Property Controlling in Section	S___ T___ R___	_____
	S___ T___ R___	_____
3. Miscellaneous Property in Sec.	S___ T___ R___	_____
	S___ T___ R___	_____
4. Lot No. _____, Recorded Plat _____		
5. Private Claims _____		

Register of Deeds Stamp & File Number

A	B	C	D	E	F	G	H	I	J	K	L	M
1												
2	5	5	4	3								
3												
4	7	8	9	10	11	12						
5												
6	18	17	16	15	14	13						
7												
8	19	20	21	22	23	24						
9												
10	30	29	28	27	26	25						
11												
12	31	32	33	34	35	36						
13												

I, Randal D. Feenstra, in a field survey on August 18, 1998 do hereby state that under requirements of P.A. 74, Michigan P.A. of 1970, the corner points mentioned in lines 1 and 2 above were in conformance with regulations and rules therefore as required in the current manual of survey instructions of the United States Department of the Interior, Bureau of Land Management or by a decree of a Court of Law and/or that the corner points mentioned in lines 3, 4 and 5 above were in conformance with the rules of the Michigan Board of Land Surveyors or by a Decree of a Court of Law, established, re-established, monumented, recovered, found as expressed below:

NOTE: Not more than 2 corners, all in the same town and range, may be recorded on this certificate.

A. Description of original monument and accessories and/or subsequent restoration:

G.L.O. (1837)
Not Set

No other information available

B. Description of corner evidence found and/or method applied in restoring or reestablishing corner:

Found: Nothing at corner - found no real occupation line to South
Held 1/2 way between G-1 and I-1 on line with H-13 and I-13 Casnovia Township. (See sketch on back)
This position not established by original government surveyors. This location is accepted as the best available evidence of the position of the corner

C. Description of monument for corner and accessories established to perpetuate locating the position of the corner:

- Set Ottawa County Remon Bar and Cap in new Monument Box
- Set Ottawa County Remon Nail & Tag in W side P. Pole
- Set Ottawa County Remon Nail & Tag in W end 12" CPP Culv.
- Set Ottawa County Remon Nail & Tag in S side 8" Maple
- Set 1/2 Rebar - 24.5' N of Edge of Blacktop
- Muskegon Corner - cast Iron Monument in Bit. - W 42.95'
- On CL, E/W Bit. Road (Sherman St.)

AZ 172°57' 91.70'
AZ 211°45' 33.36'
AZ 74°55' 169.99'
AZ 295°35' 80.37'

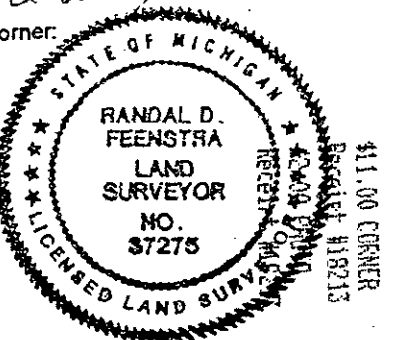

October 16, 1998

Signed by Randal D. Feenstra
Surveyor's Michigan License No. 37275

Date

SURVEY &
REMONUMENTATION

JUN 28 1999

SECTION

