

SURVEY & REMONUMENTATION

APR 24 1995

COMMISSION

For corners in
Ottawa

**OTTAWA COUNTY REMONUMENTATION
LAND CORNER RECORDATION CERTIFICATE
Filing Requirement of Act 74, Mich. P.A. 1970**

RECORDED

94 DEC 15 AM 11:47

Daphne Whitcomb
REGISTER OF DEEDS
OTTAWA COUNTY, MI

Located In:	Corner Code #
1. Public Land Survey	T 9N R 13W H-3, N 1/4 Cor.
	T R Sec. 10
	T R Chester Twp.
	T R
	T R
2. Property Controlling in Section	S T R
	S T R
3. Miscellaneous Property in Sec.	S T R
	S T R
4. Lot No. _____, Recorded Plat _____	
5. Private Claims _____	

Register of Deeds Stamp & File Number

	A	B	C	D	E	F	G	H	I	J	K	L	M
2	6	5	4	3	2	1							
3													
4	7	8	9	10	11	12							
5													
6	13	17	16	15	14	13							
7													
8	19	20	21	22	23	24							
9													
10	30	29	28	27	26	25							
11													
12	31	32	33	34	35	36							
13													

I, Randal D. Feenstra, in a field survey on December 8, 1994, do hereby certify that under requirements of P.A. 74, Michigan P.A. of 1970, the corner points mentioned in lines 1 and 2 above were in conformance with regulations and rules therefore as required in the current manual of survey instructions of the United States Department of the Interior, Bureau of Land Management or by a decree of a Court of Law and/or that the corner points mentioned in lines 3, 4 and 5 above were in conformance with the rules of the Michigan Board of Land Surveyors or by a Decree of a Court of Law; established, re-established, monumented, re-monumented, recovered, found as expressed below:

NOTE: Not more than 4 corners, all in the same town and range, may be recorded on this certificate.

- A. Description of original monument and accessories and/or subsequent restoration:
- | | |
|-----------------------------|-------------------------|
| G.L.O. by Rasselas Whitcomb | L-5, P-46 (1983) |
| Sept. 17, 1838 | C.I.M. |
| POST | 18" Ash SSE 57.35' |
| 10" Willow N84 W 8 links | 10" Tw. Maple SE 57.30' |
| 4" Willow N89 E 10 links | 12" Maple NE 51.69' |
| | 6" Apple NNW 43.80' |

- B. Description of corner evidence found and/or method applied in restoring or reestablishing corner:
Found: C.I.M. in box and is accepted as a careful and faithful perpetuation of the position of the original corner.

Found Witnesses:

- | | |
|------------------------------|------------|
| Nail in N side Tw. 10" Maple | SE 57.26' |
| Nail in SE side 14" Maple | NE 51.68' |
| Nail in E side 10" Apple | NNW 43.78' |

PA. 345 OTTAWA COUNTY
PEER APPROVED 12/2/94
Rodney D. Medewell

- C. Description of monument for corner and accessories established to perpetuate locating the position of the corner:

- | | |
|--|---------------|
| H-3 C.I.M. in box | |
| O.C. Remon. Nail & Tag in N side Tw. 10" Maple | S55 E 57.25' |
| O.C. Remon. Nail & Tag in SE side 14" Maple | N45 E 51.68' |
| O.C. Remon. Nail & Tag in E side 10" Apple | N20 W 43.68' |
| "X" in S end 42" Conc. Culv. | S 05 E 32.04' |
| 0.5' S of CL Truman and 5'W of Ditch to South | |

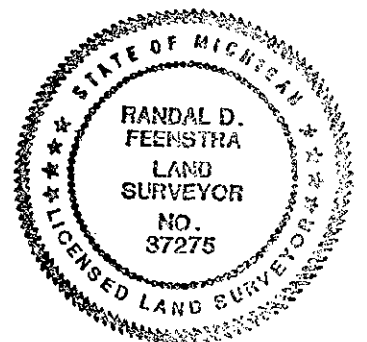

Randal D. Feenstra

Signed by Randal D. Feenstra Date December 8, 1994
Surveyor's Michigan License No. 37275