

**SURVEY & REMONUMENTATION**

APR 05 1996

**OTTAWA COUNTY REMONUMENTATION**

**COMMISSION**

**LAND CORNER RECORDATION CERTIFICATE**  
Filing Requirement of Act 74, Mich. P.A. 1970

For corners in <u>Ottawa</u> (County)	Located In:	Corner Code #
	Chester Twp. 9N 13W	H-9, S 1/4 cor. Sec. 22
1. Public Land Survey	T ___ R ___	_____
	T ___ R ___	_____
	T ___ R ___	_____
	T ___ R ___	_____
2. Property Controlling in Section	S ___ T ___ R ___	_____
	S ___ T ___ R ___	_____
3. Miscellaneous Property in Sec.	S ___ T ___ R ___	_____
	S ___ T ___ R ___	_____

**RECORDED**  
95 NOV 29 PM 1:36

*Phyllis R. Williams*  
REGISTER OF DEEDS  
OTTAWA COUNTY, MI

Register of Deeds Stamp & File Number

4. Lot No. \_\_\_\_\_, Recorded Plat \_\_\_\_\_  
5. Private Claims \_\_\_\_\_

I, Randal D. Feenstra, in a field survey on Nov 6, 1995, do hereby state that under requirements of P.A. 74, Michigan P.A. of 1970, the corner points mentioned in lines 1 and 2 above were in conformance with regulations and rules therefore as required in the current manual of survey instructions of the United States Department of the Interior, Bureau of Land Management or by a decree of a Court of Law and /or that the corner points mentioned in lines 3, 4 and 5 above were in conformance with the rules of the Michigan Board of Land Surveyors or by a Decree of a Court of Law, established, re-established, monumented, recovered, found as expressed below:

NOTE: Not more than 2 corners, all in the same town and range, may be recorded on this certificate.

1	A	B	C	D	E	F	G	H	I	J	K	L	M
2		6		5		4		3		2		1	
3													
4		7		8		9		10		11		12	
5													
6		18		17		16		15		14		13	
7													
8		19		20		21		22		23		24	
9													
10		30		29		28		27		26		25	
11													
12		31		32		33		34		35		36	
13													

A. Description of original monument and accessories and/or subsequent restoration:

G.L.O. (1838)	L-3, P-110, (1976)	L-6, P-111 (1991)
Rasselas Whitcomb	Iron Pipe	C.I.M.
10" Lynn N17°E 13 lks.	P. Pole SSW 44.20'	Wood Post NW 40.50'
10" Beech S47°W 4 lks	F. Post ESE 39.15'	P. Pole S 44.13'
		1/2" Rod NE 38.65'

B. Description of corner evidence found and/or method applied in restoring or reestablishing corner:

Found: C.I.M. in mon.box Accepted as a careful and faithful perpetuation of the position of the original corner.

Nail SW side Wood Post NW 40.51'  
Nail E. side P. Pole S 44.02'  
1/2" Rod NE 38.66'

P.A. 0-45 OTTAWA COUNTY  
PEER APPROVED 11/20/95

*Randal D. Feenstra*

C. Description of monument for corner and accessories established to perpetuate locating the position of the corner:

<del>6-10</del> H-9 C.I.M. in box		
Set Ottawa County Remon Nail & Tag SW side Wood Post	N39°W	40.53'
Set Ottawa County Remon Nail & Tag E side P. Pole	S9°W	44.03'
Set Ottawa County Remon Nail & Tag N side P. Pole	S81°W	270.83'
1/2" Rod	N64°E	38.66'

0.5' N of centerline Coolidge St.

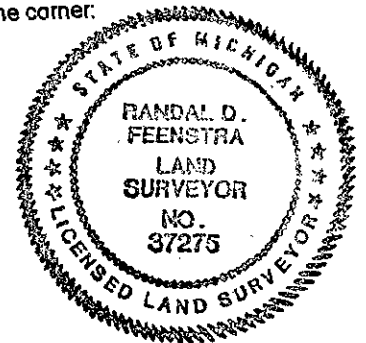

Signed by Randal D. Feenstra  
Surveyor's Michigan License No. 37275

Date November 6, 1995