

SURVEY & REMONUMENTATION

FEB 27 1998

OTTAWA COUNTY REMONUMENTATION

SECTION

LAND CORNER RECORDATION CERTIFICATE Filing Requirement of Act 74, Mich. P.A. 1970

For corners in

Ottawa

(County)

Located In:

Corner Code #

		Chester Twp.	
		9N 13W	I-1, NW cor.
1. Public Land Survey	T	R	Sec. 2
	T	R	
	T	R	
	T	R	
2. Property Controlling in Section	S	T	R
	S	T	R
3. Miscellaneous Property in Sec.	S	T	R
	S	T	R

RECORDED

97 DEC -8 AM 11:31

Randy D. Feenstra
REGISTER OF DEEDS
OTTAWA COUNTY, MI

Register of Deeds Stamp & File Number

4. Lot No. _____, Recorded Plat _____
5. Private Claims _____

I, Randal D. Feenstra, in a field survey on Feb. 27, 1997 do hereby state that under requirements of P.A. 74, Michigan P.A. of 1970, the corner points mentioned in lines 1 and 2 above were in conformance with regulations and rules therefore as required in the current manual of survey instructions of the United States Department of the Interior, Bureau of Land Management or by a decree of a Court of Law and /or that the corner points mentioned in lines 3, 4 and 5 above were in conformance with the rules of the Michigan Board of Land Surveyors or by a Decree of a Court of Law, established, re-established, monumented, recovered, found as expressed below:

NOTE: Not more than 2 corners, all in the same town and range, may be recorded on this certificate.

A	B	C	D	E	F	G	H	I	J	K	L	M
1												
2	6	5	4	3	2	1						
3												
4	7	8	9	10	11	12						
5												
6	18	17	16	15	14	13						
7												
8	19	20	21	22	23	24						
9												
10	30	29	28	27	26	25						
11												
12	31	32	33	34	35	36						
13												

A. Description of original monument and accessories and/or subsequent restoration:

G.L.O. (1838)	L-4, P-267 (1981)	
Rasselas Whitcomb	Set Cast Iron Monument	
To N. Boundary 118 Links E. of Post	Power Pole	SE 98.11
5" Beech S. 50° W 19 Links	Tele. Pedestal	SW 65.50
10" Beech S. 50° E 20 Links	St. Sign	NW 54.35
	Muskegon Cor.	W 77.87

NOTE: C.I.M. REPLACED A FOUND RAILROAD SPIKE USED IN PREVIOUS WORK.

B. Description of corner evidence found and/or method applied in restoring or reestablishing corner:

Found: Cast Iron Monument

Tele. Pedestal S 30°W 65.50'
Found 1" Iron pipe for the Muskegon County Corner W 77.87'

P.A. 345 OTTAWA COUNTY
PEER APPROVED 8-18-97
YD77

Accepted as a careful and faithful perpetuation of the position of the original corner.

C. Description of monument for corner and accessories established to perpetuate locating the position of the corner:

I-1 Set box around a found Cast Iron Monument, on townline to North

1' North of Centerline Sherman and 1' East of Centerline 16th Ave.	
MUSKEGON COR. (1" PIPE)	W. 77.87'
Set Ottawa County Remon Nail & Tag in SE side P. Pole	S 45°W 131.77'
Set Ottawa County Remon Nail & Tag in NE side P. Pole	S 48°E 147.03'
Set Ottawa County Remon Nail & Tag in SW side P. Pole	N 70°W 158.70'
Tele. Pedestal	S 30°W 65.50'
Tele. Pedestal	S 20°W 100.40'

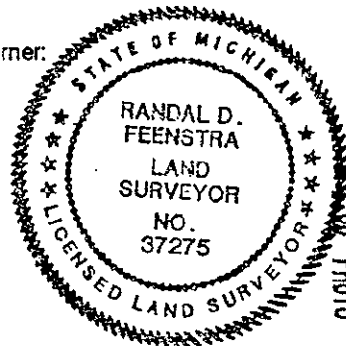

Signed by Randal D. Feenstra
Surveyor's Michigan License No. 37275

Date February 27, 1997