

# SURVEY & REMONUMENTATION

NOV 10 1993

## COMMISSION

### LAND CORNER RECORDATION CERTIFICATE Filing Requirement of Act 74, Mich. P.A. 1970

For corners in

OTTAWA COUNTY REMONUMENTATION

RECORDED

1993 SEP 29 PM 3:14

OTTAWA  
(County)

Located In: Corner Code ##

- |                                    |                         |                             |
|------------------------------------|-------------------------|-----------------------------|
| 1. Public Land Survey              | T 9N R 13W              | I-7 SW Cor-14               |
|                                    | T 9N R 13W              | J-7, S $\frac{1}{2}$ Cor-14 |
|                                    | T _____ R _____         | CHESTER TWP.                |
|                                    | T _____ R _____         |                             |
| 2. Property Controlling in Section | S _____ T _____ R _____ |                             |
|                                    | S _____ T _____ R _____ |                             |
| 3. Miscellaneous Property in Sec.  | S _____ T _____ R _____ |                             |
|                                    | S _____ T _____ R _____ |                             |

*Dyllis Hubbard*  
REGISTER OF DEEDS  
OTTAWA COUNTY, MI

Register of Deeds Stamp & File Number

4. Lot No. \_\_\_\_\_, Recorded Plat \_\_\_\_\_  
5. Private Claims \_\_\_\_\_

	A	B	C	D	E	F	G	H	I	J	K	L	M
2	6	5	4	3	2	1							
3													
4	7	8	9	10	11	12							
5													
6	18	17	16	15	14	13							
7													
8	19	20	21	22	23	24							
9													
10	30	29	28	27	26	25							
11													
12	31	32	33	34	35	36							
13													

I, Randal D. Feenstra in a field survey on July 20, 19 93, do hereby certify that under requirements of P.A. 74, Michigan P.A. of 1970, the corner points mentioned in lines 1 and 2 above were in conformance with regulations and rules therefore as required in the current manual of survey instructions of the United States Department of the Interior, Bureau of Land Management or by a decree of a Court of Law and/or that the corner points mentioned in lines 3, 4 and 5 above were in conformance with the rules of the Michigan Board of Land Surveyors or by a Decree of a Court of Law; established, re-established, monumented, re-monumented, recovered, found as expressed below:

**NOTE: Not more than 4 corners, all in the same town and range, may be recorded on this certificate.**

A. Description of original monument and accessories and/or subsequent restoration:

I-7 = LCRC#'s L-6, P-108

J-7 = LCRC#'s L-6, P-108

B. Description of corner evidence found and/or method applied in restoring or reestablishing corner:

I-7 J-7

Found Cast Iron Monument in Box  
And Witnesses per L-6, P-108  
LCRC # L-6, P-108

Found Cast Iron Monument in Box  
And Witnesses per L-6, P-108  
LCRC # L-6, P-108

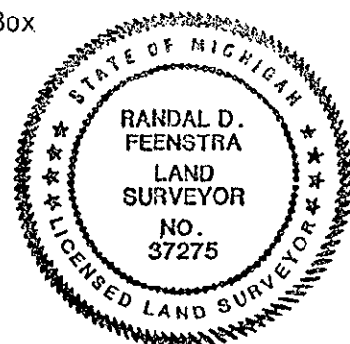

C. Description of monument for corner and accessories established to perpetuate locating the position of the corner:

- I-7-Cast Iron Monument per L-6, P-108, Ottawa County, MI, and is accepted as a careful and faithful perpetuation of the position of the original corner.
  - O.C. Remon. Nail & Tag in Power Pole S70°W 41.63
  - O.C. Remon. Nail & Tag in Apple Tree N60°E 84.80
  - O.C. Remon. Nail & Tag in Power Pole N15°W 94.20
  - SE Cor. Bldg. Found N40°W 65.36
  - CL of 16th West 0.5' CL of Gooding 6.0' North
- J-7-Cast Iron Monument per L-6, P-108, Ottawa County, MI, and is accepted as a careful and faithful perpetuation of the position of the original corner.
  - O.C. Remon. Nail & Tag in 14" Spruce S15°W 48.57
  - O.C. Remon. Nail & Tag in 6" Spruce S50°W 60.38
  - O.C. Remon. Nail & Tag in Fence Post N20°E 30.70
  - O.C. Remon. Nail & Tag in Fence Post N65°W 58.62

@ CL of Gooding, lines up with East side Barn and fence line to North

Signed by Randal D. Feenstra Date July 20, 1993

Surveyor's Michigan License No. 37275