

SURVEY & REMONUMENTATION

JUN 28 1999

SECTION

10/19/98 OTTAWA COUNTY REMONUMENTATION LAND CORNER RECORDATION CERTIFICATE
Filing Requirement of Act 74, Mich. P.A. 1970

RECORDED

98 NOV -4 PM 2: 30

Randy Feenstra
REGISTER OF DEEDS
OTTAWA COUNTY, MI

For corners in

Ottawa (County)	Located In:	Corner Code #
1. Public Land Survey	Chester Twp. 9N 13W	18.
	T___ R___	E 1/4 Cor., Sec 15
	T___ R___	SEC. 22
	T___ R___	
	T___ R___	
2. Property Controlling in Section	S___ T___ R___	
	S___ T___ R___	
3. Miscellaneous Property in Sec.	S___ T___ R___	
	S___ T___ R___	
4. Lot No. _____, Recorded Plat _____		
5. Private Claims _____		

Register of Deeds Stamp & File Number

I, Randal D. Feenstra, in a field survey on August 18, 19 98 do hereby state that under requirements of P.A. 74, Michigan P.A. of 1970, the corner points mentioned in lines 1 and 2 above were in conformance with regulations and rules therefore as required in the current manual of survey instructions of the United States Department of the Interior, Bureau of Land Management or by a decree of a Court of Law and/or that the corner points mentioned in lines 3, 4 and 5 above were in conformance with the rules of the Michigan Board of Land Surveyors or by a Decree of a Court of Law, established, re-established, monumented, recovered, found as expressed below.

NOTE: Not more than 2 corners, all in the same town and range, may be recorded on this certificate.

A	B	C	D	E	F	G	H	I	J	K	L	M
1												
2	6	5	4	3	2	1						
3												
4	7	8	9	10	11	12						
5												
6	18	17	16	15	14	13						
7												
8	19	20	21	22	23	24						
9												
10	30	29	28	27	26	25						
11												
12	31	32	33	34	35	36						
13												

A. Description of original monument and accessories and/or subsequent restoration:

G.L.O. (1838)		Liber 6, P. 271	
Rasselus Whitcomb		R.R. spike 0.6' W of CL bit.	
14" Beech	N55°E 16 lks.	Found Nail N Side P.P.	W 43.70
10" Elm	S65°W 14 lks.	Top CL N. End 12" CMP Culv.	S05°E 133.43

B. Description of corner evidence found and/or method applied in restoring or reestablishing corner.

Found: Nothing in road - set P.K. at 1/2 way point on line between I-7 and I-9
Accepted as a careful and faithful perpetuation of the position of the original corner.

Found Nail N side P. Pole	261°45'	43.65'
Top CL N. End 12" CMP Culv.	168°	133.35'
Found Nail E side P. Pole	353°15'	366.28'
CL N-S Bit. Rd. (16th Ave.)	0.6'E	

C. Description of monument for corner and accessories established to perpetuate locating the position of the corner:

Set	Ottawa County Remon Bar and Cap and Monument Box	168°	133.47'
Set	Ottawa County Remon Nail & Tag in N end 12" CMP Culv.	186°45'	363.96'
Set	Ottawa County Remon Nail & Tag in E side P. Pole (3' above gnd)	261°45'	43.67'
Set	Ottawa County Remon Nail & Tag in N side P. Pole	353°15'	366.28'
Set	Ottawa County Remon Nail & Tag in E side P. Pole (6' above gnd)		
	CL N-S Bit. Rd. (16th Ave.) 0.6'E		

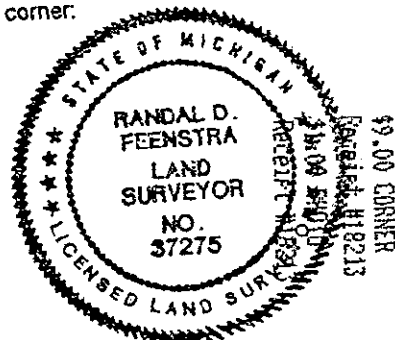

Signed by Randal D. Feenstra
Surveyor's Michigan License No. 37275

Date Aug. 19, 1998

August 19, 1998