

**SURVEY & REMONUMENTATION**

APR 05 1996

**OTTAWA COUNTY REMONUMENTATION**

**COMMISSION**

**LAND CORNER RECORDATION CERTIFICATE**  
Filing Requirement of Act 74, Mich. P.A. 1970

For corners in  
Ottawa

(County)	Located in:	Corner Code #
	Chester Twp.	
1. Public Land Survey	9N 13W	I-10, E 1/4 cor.
	T___ R___	Sec. 27
	T___ R___	
	T___ R___	
	T___ R___	
2. Property Controlling in Section	S___ T___ R___	
	S___ T___ R___	
3. Miscellaneous Property in Sec.	S___ T___ R___	
	S___ T___ R___	

**RECORDED**

95 NOV 29 PM 1:35

*Ralph D. Feenstra*  
REGISTER OF DEEDS  
OTTAWA COUNTY, MI

Register of Deeds Stamp & File Number

4. Lot No. \_\_\_\_\_, Recorded Plat \_\_\_\_\_  
5. Private Claims \_\_\_\_\_

I, Randal D. Feenstra, in a field survey on Nov 6, 1995 do hereby state that under requirements of P.A. 74, Michigan P.A. of 1970, the corner points mentioned in lines 1 and 2 above were in conformance with regulations and rules therefore as required in the current manual of survey instructions of the United States Department of the Interior, Bureau of Land Management or by a decree of a Court of Law and/or that the corner points mentioned in lines 3, 4 and 5 above were in conformance with the rules of the Michigan Board of Land Surveyors or by a Decree of a Court of Law; established, re-established, monumented, recovered, found as expressed below:

NOTE: Not more than 2 corners, all in the same town and range, may be recorded on this certificate.

	A	B	C	D	E	F	G	H	I	J	K	L	M
1													
2	6			5			4			3		2	1
3													
4	7			8			9			10		11	12
5													
6	18			17			16			15		14	13
7													
8	19			20			21			22		23	24
9													
10	30			29			28			27		26	25
11													
12	31			32			33			34		35	36
13													

A. Description of original monument and accessories and/or subsequent restoration:

G.L.O. (1838)	L-2, P-183, (1973)
Rasselas Witcomb	"T" Iron
40" W. Ash S40°W 4 lks.	10" Maple NW 49.93'
12" Sugar N40°E 6 lks	8" Maple SW 39.87'
	Fence Post SE 36.96'
	Fence Post SSE 63.40'

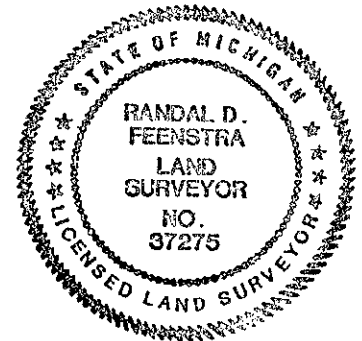

B. Description of corner evidence found and/or method applied in restoring or reestablishing corner:

Found: 3/4" Iron Rod in Mon. Box: Accepted as a careful and faithful perpetuation of the position of the original corner.

RA. 045 OTTAWA COUNTY  
PEER APPROVED 11/20/95

*Randal D. Feenstra*  
207

C. Description of monument for corner and accessories established to perpetuate locating the position of the corner:

- I-10 Set Ottawa County Remon. Bar & Cap in box
- Set Ottawa County Remon Nail & Tag in S 12" CMP N78°W 27.17'
- Set Ottawa County Remon Nail & Tag E side 6" Basswood N21°W 99.67'
- Set Ottawa County Remon Nail & Tag N side Twin 8" Elm N77°E 136.22'
- Set Ottawa County Remon Nail & Tag NW side 4" Apple Tree S57°W 60.43'

Centerline 16th Avenue (Bit Road) 0.5' E

Signed by *Randal D. Feenstra*  
Surveyor's Michigan License No. 37275

Date November 6, 1995