

SURVEY & REMONUMENTATION

OCT 24 1994

COMMISSION

**OTTAWA COUNTY REMONUMENTATION
LAND CORNER RECORDATION CERTIFICATE
Filing Requirement of Act 74, Mich. P.A. 1970**

RECORDED

94 OCT -7 PM 12:34

R. J. ...
REGISTER OF DEEDS
OTTAWA COUNTY, MI

For corners in

Ottawa (County)	Located In:	Corner Code #
1. Public Land Survey	T 9N R 13W	I-11, NW COR Sec. 35, Chester
	T _____ R _____	_____
	T _____ R _____	_____
	T _____ R _____	_____
2. Property Controlling in Section	S _____ T _____ R _____	_____
	S _____ T _____ R _____	_____
3. Miscellaneous Property in Sec.	S _____ T _____ R _____	_____
	S _____ T _____ R _____	_____

Register of Deeds Stamp & File Number

4. Lot No. _____, Recorded Plat _____
5. Private Claims _____

I, Randal D. Feenstra in a field survey on May 20, 19 94, do hereby certify that under requirements of P.A. 74, Michigan P.A. of 1970, the corner points mentioned in lines 1 and 2 above were in conformance with regulations and rules therefore as required in the current manual of survey instructions of the United States Department of the Interior, Bureau of Land Management or by a decree of a Court of Law and/or that the corner points mentioned in lines 3, 4 and 5 above were in conformance with the rules of the Michigan Board of Land Surveyors or by a Decree of a Court of Law; established, re-established, monumented, re-monumented, recovered, found as expressed below:

NOTE: Not more than 4 corners, all in the same town and range, may be recorded on this certificate.

	A	B	C	D	E	F	G	H	I	J	K	L	M
2	6		5		4		3		2		1		
3													
4	7		8		9		10		11		12		
5													
6	18		17		16		15		14		13		
7													
8	19		20		21		22		23		24		
9													
10	30		29		28		27		26		25		
11													
12	31		32		33		34		35		36		
13													

A. Description of original monument and accessories and/or subsequent restoration:

S.L.O. (1838)	Liber 2, Pg. 183 (1973)	Liber 5, pg. 258 (1986)
40" B. Oak N85°E 8.6	"T" Iron in mon. box	C.I.M.
15" Beech S60°W 22.4	NW Cor Gar Fndn SE 130.13	12" B. Spruce WSW 71.17
POST	SE Cor Hse Fndn SW 110.25	4" Apple NW 73.85
Rasselas Whitcomb	NE Cor Porch WSW 89.26	12" Maple SE 50.66
	Nail in PP ESE 59.61	PP ESE 59.58

B. Description of corner evidence found and/or method applied in restoring or reestablishing corner:

Found: C.I.M. in Box - accepted as a careful and faithful perpetuation of the position of the original corner.

Found Witnesses: Conc. Nail in E side 12" Maple	SE 50.70
Nail & tag in N side PP	ESE 59.58
Pk in N side PP	ESE 59.56
Conc. Nail in S side 14" Spruce	SW 71.13
Nail & tag in NE side 6" Apple	NW 73.78

P.A. 345 OTTAWA COUNTY

PEER APPROVED *[Signature]*

[Signature]

C. Description of monument for corner and accessories established to perpetuate locating the position of the corner:

I-11 Cast Iron Mon. in Box	
O.C. Remon. Nail & tag in W side 12" Maple	S45°E 50.71
O.C. Remon. Nail & tag in N side PP	S60°E 59.62
O.C. Remon. Nail & tag in N side 14" Spruce	S45°W 70.70
O.C. Remon. Nail & tag in S side 6" Apple	N60°W 73.81

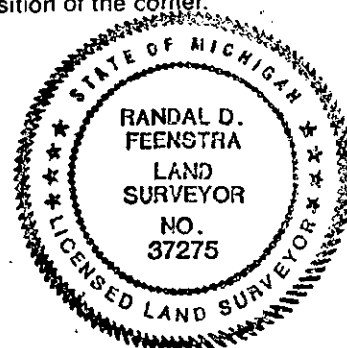

Signed by Randal D. Feenstra Date May 20, 1994

Surveyor's Michigan License No. 37275