

SURVEY & REMONUMENTATION

OCT 24 1994

COMMISSION

**OTTAWA COUNTY REMONUMENTATION
LAND CORNER RECORDATION CERTIFICATE
Filing Requirement of Act 74, Mich. P.A. 1970**

RECORDED

94 OCT -7 PM 12:34

Rudolph R. Holman
REGISTER OF DEEDS
OTTAWA COUNTY, MI

For corners in

Ottawa

(County)

Located In:

Corner Code ##

- | | | |
|------------------------------------|--------------------------|----------------------------------|
| 1. Public Land Survey | T <u>9N</u> R <u>13W</u> | I-13, SW COR
Sec. 35, Chester |
| | T _____ R _____ | _____ |
| | T _____ R _____ | _____ |
| | T _____ R _____ | _____ |
| 2. Property Controlling in Section | S _____ T _____ R _____ | _____ |
| | S _____ T _____ R _____ | _____ |
| 3. Miscellaneous Property in Sec. | S _____ T _____ R _____ | _____ |
| | S _____ T _____ R _____ | _____ |

Register of Deeds Stamp & File Number

4. Lot No. _____, Recorded Plat _____
5. Private Claims _____

	A	B	C	D	E	F	G	H	I	J	K	L	M
2	6		5		4		3		2		1		
3													
4	7		8		9		10		11		12		
5													
6	18		17		16		15		14		13		
7													
8	19		20		21		22		23		24		
9													
10	30		29		28		27		26		25		
11													
12	31		32		33		34		35		36		
13													

I, Randal D. Feenstra, in a field survey on May 20, 1994, do hereby certify that under requirements of P.A. 74, Michigan P.A. of 1970, the corner points mentioned in lines 1 and 2 above were in conformance with regulations and rules therefore as required in the current manual of survey instructions of the United States Department of the Interior, Bureau of Land Management or by a decree of a Court of Law and/or that the corner points mentioned in lines 3, 4 and 5 above were in conformance with the rules of the Michigan Board of Land Surveyors or by a Decree of a Court of Law; established, re-established, monumented, re-monumented, recovered, found as expressed below:

NOTE: Not more than 4 corners, all in the same town and range, may be recorded on this certificate.

A. Description of original monument and accessories and/or subsequent restoration:

L.O. (1838)	Liber 6, Page 105 (1991)
8" Beech N35°E 21.1	C.I.M.
~ Beech N74°W 33.0	14" Apple SE 56.21
OST	14" Apple SSW 47.67
asselas Whitcomb	Wright Cor E 87.13
	PP NE 68.86

B. Description of corner evidence found and/or method applied in restoring or reestablishing corner:

Found: C.I.M. in box - accepted as a careful and faithful perpetuation of the position of the original corner.

Found Witnesses:

Nail in W side PP	
Wright Twp. Corner	E 87.09
Nail in NW side PP	NE 68.86

C. Description of monument for corner and accessories established to perpetuate locating the position of the corner:

I-13 Cast Iron Mon. in Box (No Cover)	
O.C. Remon. Nail & tag in NW side PP	N50°E 68.94
O.C. Remon. Nail & tag in W side PP	S40°E 157.40
O.C. Remon. Nail & tag in W side 4" Apple	S20°E 134.67
"X" in W end 12" conc. culv.	N30°W 27.45
Wright Twp. Corner	N90°E 87.09

3' N and 3' W of CL "X" Wilson Street and 16th Avenue.

P.A. 345 OTTAWA COUNTY
PEER APPROVED 8/22/94
Gordon D. Hedewell

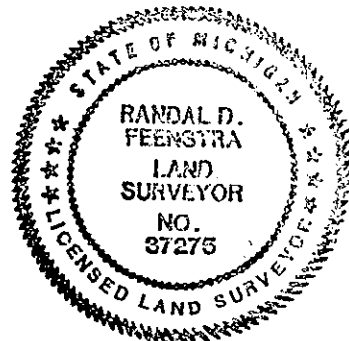

Signed by *Randal D. Feenstra* Date May 20, 1994
Surveyor's Michigan License No. 37275