

SURVEY & REMONUMENTATION

OCT 24 1994

COMMISSION

**OTTAWA COUNTY REMONUMENTATION
LAND CORNER RECORDATION CERTIFICATE
Filing Requirement of Act 74, Mich. P.A. 1970**

RECORDED

94 OCT -7 PM 12:32

For corners in
Ottawa

(County)

Located In:

Corner Code #

- | | | |
|---------------------------------------|--------------------------|-------------------------------------|
| 1. Public Land Survey | T <u>9N</u> R <u>13W</u> | J-11, N 1/4 COR
Sec. 35, Chester |
| | T ___ R ___ | _____ |
| | T ___ R ___ | _____ |
| | T ___ R ___ | _____ |
| 2. Property Controlling
in Section | S ___ T ___ R ___ | _____ |
| | S ___ T ___ R ___ | _____ |
| 3. Miscellaneous
Property in Sec. | S ___ T ___ R ___ | _____ |
| | S ___ T ___ R ___ | _____ |

Doris B. Stettin
REGISTER OF DEEDS
OTTAWA COUNTY, MI

Register of Deeds Stamp & File Number

4. Lot No. _____, Recorded Plat _____
5. Private Claims _____

A	B	C	D	E	F	G	H	I	J	K	L	M
2	6	5	4	3	2	1						
3												
4	7	8	9	10	11	12						
5												
6	18	17	16	15	14	13						
7												
8	19	20	21	22	23	24						
9												
10	30	29	28	27	26	25						
11												
12	31	32	33	34	35	36						
13												

I, Randal D. Feenstra, in a field survey on May 20, 19 94, do hereby certify that under requirements of P.A. 74, Michigan P.A. of 1970, the corner points mentioned in lines 1 and 2 above were in conformance with regulations and rules therefore as required in the current manual of survey instructions of the United States Department of the Interior, Bureau of Land Management or by a decree of a Court of Law and/or that the corner points mentioned in lines 3, 4 and 5 above were in conformance with the rules of the Michigan Board of Land Surveyors or by a Decree of a Court of Law; established, re-established, monumented, re-monumented, recovered, found as expressed below:

NOTE: Not more than 4 corners, all in the same town and range, may be recorded on this certificate.

A. Description of original monument and accessories and/or subsequent restoration:

L.O. (1838) Liber 2, Pg. 183 (1973) Liber 5, Pg. 252 (1986)

Tree N26°E 7.3	Tree Iron in Mon. Box	C.I.M.	
Sugar SO9°W 14.5	PP S 60.30	Fence Post	S 31.65
OST 24" Ash	71.28	38" Tree	SW 71.60
asselas Whitcomb	CPC Iron 33.05	Fence Post	N 36.55
		8" Tree	NNE 40.83

B. Description of corner evidence found and/or method applied in restoring or reestablishing corner:

Found: C.I.M. in Box - accepted as a careful and faithful perpetuation of the position of the original corner.

Found Witnesses:

Nail in N side PP S 59.87
Nail & tag in E side fence post S 31.65

PA. 345 OTTAWA COUNTY

PEER APPROVED B/22/94

Gordon D. Hedewell

C. Description of monument for corner and accessories established to perpetuate locating the position of the corner:

J-11 Cast Iron Mon. in Box (No cover)	
O.C. Remon. Nail & tag in N side 28" Basswood	S60°W 71.11
O.C. Remon. Nail & tag in NW side PP	S00°E 60.14
O.C. Remon. Nail & tag in SE side 10" Elm	N30°E 42.28
O.C. Remon. Nail & tag in S side 4" Twin Maple	N70°W 80.25
On CL Harding Street	

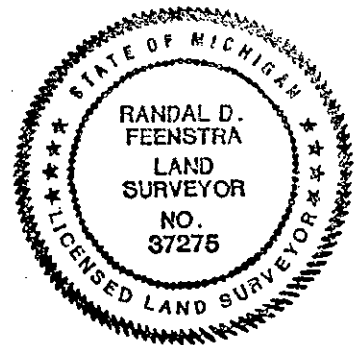

Signed by Randal D. Feenstra

Date May 20, 1994

Surveyor's Michigan License No. 37275