

**SURVEY & REMONUMENTATION**

DEC 16 1996

COMMISSION

**OTTAWA COUNTY REMONUMENTATION  
LAND CORNER RECORDATION CERTIFICATE**  
Filing Requirement of Act 74, Mich. P.A. 1970

For corners in Ottawa <hr/> (County)	Located In:	Corner Code #
	Chester Twp. 9N 13W	K-2, E 1/4 cor.
1. Public Land Survey	T___ R___ T___ R___ T___ R___ T___ R___	Sec. 2
2. Property Controlling in Section	S___ T___ R___ S___ T___ R___	
3. Miscellaneous Property in Sec.	S___ T___ R___ S___ T___ R___	
4. Lot No. _____, Recorded Plat _____		
5. Private Claims _____		

**RECORDED**  
96 NOV 14 AM 11:20  
*Randal D. Feenstra*  
REGISTER OF DEEDS  
OTTAWA COUNTY, MI  
**Register of Deeds Stamp & File Number**

I, Randal D. Feenstra, in a field survey on March 25, 19 96 do hereby state that under requirements of P.A. 74, Michigan P.A. of 1970, the corner points mentioned in lines 1 and 2 above were in conformance with regulations and rules therefore as required in the current manual of survey instructions of the United States Department of the Interior, Bureau of Land Management or by a decree of a Court of Law and /or that the corner points mentioned in lines 3, 4 and 5 above were in conformance with the rules of the Michigan Board of Land Surveyors or by a Decree of a Court of Law; established, re-established, monumented, recovered, found as expressed below:

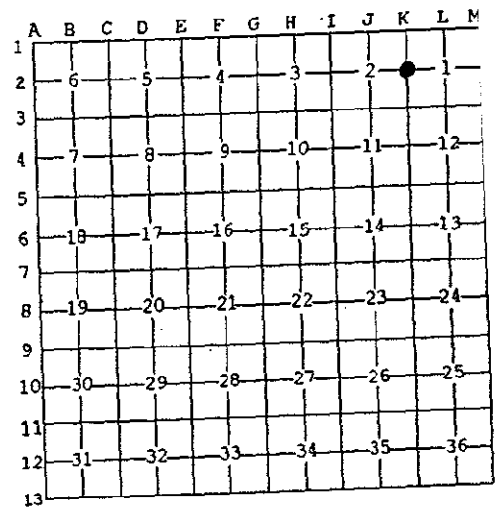

**NOTE:** Not more than 2 corners, all in the same town and range, may be recorded on this certificate.

A. Description of original monument and accessories and/or subsequent restoration:

G.L.O. (1838)	L-4, P-264, (1981)
Rasselas Whitcomb	CIM
Post	5" Cherry ENE 27.47'
11" Iron Wood S60°W 24 lks	8" Cherry WNW 25.68'
14" Sugar Maple S58°E 31 lks	12" Ash NNW 85.91'
	2nd fence post North of cor. post NE 50.17'

B. Description of corner evidence found and/or method applied in restoring or reestablishing corner:

K-2 Cast Iron Monument in Gravel	Accepted as a careful and faithful perpetuation of the position of the original corner.
Nail & Tag in E side 18" Ash Az. 346° 85.78'	
Nail in N side 8" Cherry Az. 75° 27.38'	

P.A. 345 OTTAWA COUNTY  
PEER APPROVED 9-16-96  
*R.D.F.*

C. Description of monument for corner and accessories established to perpetuate locating the position of the corner:

K-2 Cast Iron Monument in Gravel Road	
Ottawa County Remon Nail & Tag in S side 8" Beech	Az. 313° 43.35'
Ottawa County Remon Nail & Tag in E side 18" Ash	Az. 346° 86.20'
Ottawa County Remon Nail & Tag in top fence post	Az. 23° 76.42'
Ottawa County Remon Nail & Tag in N side 8" Cherry	Az. 75° 27.38'
CL 8th Ave. (gravel) N&S 3.0'W	

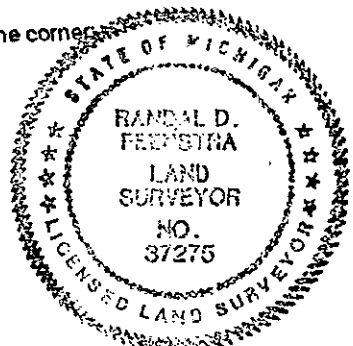

Signed by *Randal D. Feenstra*  
Surveyor's Michigan License No. 37275

Date September 16, 1996