

SURVEY & REMONUMENTATION

APR 24 1995

COMMISSION

OTTAWA COUNTY REMONUMENTATION LAND CORNER RECORDATION CERTIFICATE Filing Requirement of Act 74, Mich. P.A. 1970

RECORDED

94 DEC 15 AM 11:48

R. J. Callman
REGISTER OF DEEDS
OTTAWA COUNTY, MI

For corners in
Ottawa
(County)

Located In: Corner Code #

1. Public Land Survey	T <u>9N</u> R <u>13W</u>	K-3, NE Cor.
	T _____ R _____	Sec. 11
	T _____ R _____	Chester Twp.
	T _____ R _____	
2. Property Controlling in Section	S _____ T _____ R _____	
	S _____ T _____ R _____	
3. Miscellaneous Property in Sec.	S _____ T _____ R _____	
	S _____ T _____ R _____	

Register of Deeds Stamp & File Number

4. Lot No. _____, Recorded Plat _____
5. Private Claims _____

	A	B	C	D	E	F	G	H	I	J	K	L	M
2	6	5	4		3		2		1				
3													
4	7	8	9	10	11	12							
5													
6	18	17	16	15	14	13							
7													
8	19	20	21	22	23	24							
9													
10	30	29	28	27	26	25							
11													
12	31	32	33	34	35	36							
13													

I, Randal D. Feenstra on December 8 1994
do hereby certify that under requirements of P.A. 74, Michigan P.A. of 1970, the corner points mentioned in lines 1 and 2 above were in conformance with regulations and rules therefore as required in the current manual of survey instructions of the United States Department of the Interior, Bureau of Land Management or by a decree of a Court of Law and/or that the corner points mentioned in lines 3, 4 and 5 above were in conformance with the rules of the Michigan Board of Land Surveyors or by a Decree of a Court of Law; established, re-established, monumented, re-monumented, recovered, found as expressed below:

NOTE: Not more than 4 corners, all in the same town and range, may be recorded on this certificate.

A. Description of original monument and accessories and/or subsequent restoration:
 G.L.O. by Rasselas Whitcomb L-2, P-519, 1974 L-5, P-139, 1983
 Sept. 17, 1838 Iron in Mon. Box C.I.M.
 POST CL B.T. Top E-W Grv. N-S P.P. SW 80.20
 9" Beech N4 W 22 links "X" on SE Cor. Hdwl S64 E 44.95' Stop Sign NW 48.10
 10" Beech S39 W 13 links P.P. S27 W 80.24' "x" on NE Cor. Hdwl SE 44.94
 "x" on NW cor. Hdwl NE 39.53

B. Description of corner evidence found and/or method applied in restoring or reestablishing corner:
 Found : C.I.M. box and is accepted as a careful and faithful perpetuation of the position of the original corner.

Nail in NW cor P.Pole SW 80.20'
 "X" on NE cor. Hdwl SE 44.93'
 "X" on NW cor Hdwl NE 39.55'

PA. 345 OTTAWA COUNTY
 PEER APPROVED 12/12/94
Rodney D. Hedewell

C. Description of monument for corner and accessories established to perpetuate locating the position of the corner:

K-3 C.I.M. in Box
 O.C. Remon Nail & Tag in NW side P. Pole S25 W 80.12'
 O.C. Remon Nail & Tag in N side Fence Post S50 W 51.17'
 "X" on NE Cor. Hdwl S65 E 44.93'
 "X" on NW Cor. Hdwl N65 E 33.95'
 1' S and 2' W of CL "X" Truman Street and 8th Avenue

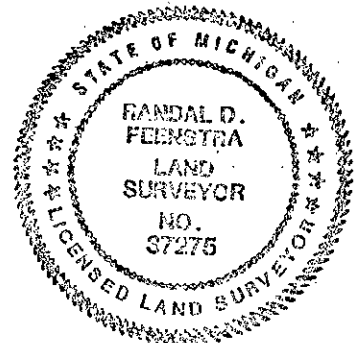

Randal D. Feenstra

Signed by Randal D. Feenstra Date December 8, 1994

Surveyor's Michigan License No. 37275