

SURVEY & REMONUMENTATION

NOV 10 1993

COMMISSION

LAND CORNER RECORDATION CERTIFICATE

Filing Requirement of Act 74, Mich. P.A. 1970

RECORDED

For corners in

OTTAWA COUNTY REMONUMENTATION

1993 SEP 29 PM 3:14

OTTAWA
(County)

Located In: Corner Code #

- | | | |
|------------------------------------|--------------------------|--------------------------|
| 1. Public Land Survey | T <u>9N</u> R <u>13W</u> | <u>K-5 NE Cor-14</u> |
| | T <u>9N</u> R <u>13W</u> | <u>K-6, E 1/2 Cor-14</u> |
| | T _____ R _____ | <u>CHESTER TWP.</u> |
| | T _____ R _____ | _____ |
| 2. Property Controlling in Section | S _____ T _____ R _____ | _____ |
| | S _____ T _____ R _____ | _____ |
| 3. Miscellaneous Property in Sec. | S _____ T _____ R _____ | _____ |
| | S _____ T _____ R _____ | _____ |

Ryelle Johnson
REGISTER OF DEEDS
OTTAWA COUNTY, MI

Register of Deeds Stamp & File Number

4. Lot No. _____, Recorded Plat _____
5. Private Claims _____

	A	B	C	D	E	F	G	H	I	J	K	L	M
2	6	5	4	3	2	1							
3													
4	7	8	9	10	11	12							
5											•		
6	18	17	16	15	14	13					•		
7													
8	19	20	21	22	23	24							
9													
10	30	29	28	27	26	25							
11													
12	31	32	33	34	35	36							
13													

I, Randal D. Feenstra in a field survey on July 20, 19 93, do hereby certify that under requirements of P.A. 74, Michigan P.A. of 1970, the corner points mentioned in lines 1 and 2 above were in conformance with regulations and rules therefore as required in the current manual of survey instructions of the United States Department of the Interior, Bureau of Land Management or by a decree of a Court of Law and/or that the corner points mentioned in lines 3, 4 and 5 above were in conformance with the rules of the Michigan Board of Land Surveyors or by a Decree of a Court of Law; established, re-established, monumented, re-monumented, recovered, found as expressed below:

NOTE: Not more than 4 corners, all in the same town and range, may be recorded on this certificate.

A. Description of original monument and accessories and/or subsequent restoration:

K-5 = LCRC# 's L-3, P-254; L-4, P-233

K-6 = LCRC# 's L-6, P-109

B. Description of corner evidence found and/or method applied in restoring or reestablishing corner:

K-5
Found Cast Iron Monument in Box
And Witnesses Per 200
LCRC # L-4, P-233

K-6
Found Cast Iron Monument
And Witnesses Per 111
LCRC # L-6, P-109

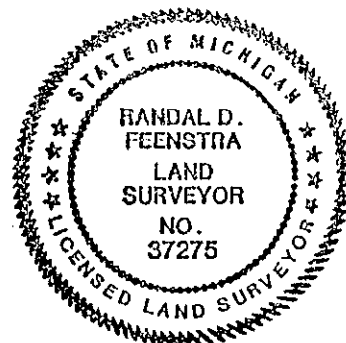

C. Description of monument for corner and accessories established to perpetuate locating the position of the corner:

- K-5 - Cast Iron Monument per L-4, P-233, Ottawa County, MI, and is accepted as a careful and faithful perpetuation of the position of the original corner.
 - O.C. Remon. Nail & Tag in Power Pole S60°W 106.83
 - "X" in North end culvert N55°E 53.61
 - "X" in South end culvert S60°E 53.78
 - O.C. Remon. Nail & Tag in Fence Post N40°W 75.74
- @ CL 8th, CL Hoover-5'N
- K-6 - Cast Iron Monument per L-6, P-109, Ottawa County, MI, and is accepted as a careful and faithful perpetuation of the position of the original corner.
 - O.C. Remon. Nail & Tag in Fence Post S40°W 67.97
 - O.C. Remon. Nail & Tag in Fence Post N60°W 50.08
 - O.C. Remon. Nail & Tag in Power Pole N10°W 159.33
 - O.C. Remon. Nail & Tag in Power Pole N90°E 166.86

Signed by Randal D. Feenstra Date July 20, 1993

Surveyor's Michigan License No. 37275