

SURVEY & REMONUMENTATION

OCT 24 1994

COMMISSION

**OTTAWA COUNTY REMONUMENTATION
LAND CORNER RECORDATION CERTIFICATE
Filing Requirement of Act 74, Mich. P.A. 1970**

RECORDED

94 OCT -7 PM 12:34

Ralph D. Hedwell
REGISTER OF DEEDS
OTTAWA COUNTY, MI

For corners in

Ottawa <small>(County)</small>	Located In:	Corner Code #
1. Public Land Survey	T 9N R 13W	K-11, NE COR Sec. 35, Chester
	T ___ R ___	_____
	T ___ R ___	_____
	T ___ R ___	_____
2. Property Controlling in Section	S ___ T ___ R ___	_____
	S ___ T ___ R ___	_____
3. Miscellaneous Property in Sec.	S ___ T ___ R ___	_____
	S ___ T ___ R ___	_____
4. Lot No. _____, Recorded Plat _____		
5. Private Claims _____		

Register of Deeds Stamp & File Number

I, Randal D. Feenstra in a field survey on May 20, 1994, do hereby certify that under requirements of P.A. 74, Michigan P.A. of 1970, the corner points mentioned in lines 1 and 2 above were in conformance with regulations and rules therefore as required in the current manual of survey instructions of the United States Department of the Interior, Bureau of Land Management or by a decree of a Court of Law and/or that the corner points mentioned in lines 3, 4 and 5 above were in conformance with the rules of the Michigan Board of Land Surveyors or by a Decree of a Court of Law; established, re-established, monumented, re-monumented, recovered, found as expressed below:

NOTE: Not more than 4 corners, all in the same town and range, may be recorded on this certificate.

	A	B	C	D	E	F	G	H	I	J	K	L	M
2	6	5	4	3	2	1							
3													
4	7	8	9	10	11	12							
5													
6	18	17	16	15	14	13							
7													
8	19	20	21	22	23	24							
9													
10	30	29	28	27	26	25							
11													
12	31	32	33	34	35	36							
13													

A. Description of original monument and accessories and/or subsequent restoration:
L.O. (1838) Liber 3, Pg. 124 (1976) Liber 5, Pg. 250 (1986)

3" Sugar	N53.5°E	2.6 1" Iron	C.I.M.	
2" Tree	S66.5°W	8.6	12" Maple	NE 92.22
POST			PP	NW 41.62
Basselas Whitcomb			PP	SSW 114.03
			TP	SE 45.96

B. Description of corner evidence found and/or method applied in restoring or reestablishing corner:

Found: C.I.M. in Box - accepted as a careful and faithful perpetuation of the position of the original corner.

Found Witnesses:

Pk in SW side PP	NW	41.60
Nail & tag in E side PP	NW	41.63
Nail in SE side PP	NW	41.19

P.A. 345 OTTAWA COUNTY

PEER APPROVED 8/22/94

Randal D. Feenstra

C. Description of monument for corner and accessories established to perpetuate locating the position of the corner:

K-11 Cast Iron Mon. in Box (No Cover)		
O.C. Remon. Nail & tag in SW side PP	N45°W	41.55
O.C. Remon. Nail & tag in W side 14" Maple	N45°E	91.45
"X" in E side 30" conc. culv.	S40°E	48.69
"X" in W side 30" conc. culv.	S40°W	48.91
1.5' S of CL "X" Harding Street and 8th Avenue		

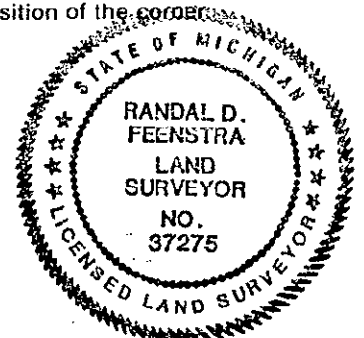

Signed by Randal D. Feenstra Date May 20, 1994

Surveyor's Michigan License No. 37275