

RE

FEB 24 2000

RECORDED

99 SEP -9 PM 12:15

SECTION

OTTAWA COUNTY REMONUMENTATION
LAND CORNER RECORDATION CERTIFICATE
Filing Requirement of Act 74, Mich. P.A. 1970

Dan Schell
REGISTER OF DEEDS
OTTAWA COUNTY, MI

For corners in

<u>Ottawa</u> (County)	Located In:	Corner Code #
	<u>Chester Twp.</u>	
1. Public Land Survey	T <u>9NR</u> <u>13W</u>	<u>K-12</u>
	T <u> </u> R <u> </u>	<u>E 1/4 Cor., Sec. 35</u>
	T <u> </u> R <u> </u>	<u> </u>
	T <u> </u> R <u> </u>	<u> </u>
2. Property Controlling in Section	S <u> </u> T <u> </u> R <u> </u>	<u> </u>
	S <u> </u> T <u> </u> R <u> </u>	<u> </u>
3. Miscellaneous Property in Sec.	S <u> </u> T <u> </u> R <u> </u>	<u> </u>
	S <u> </u> T <u> </u> R <u> </u>	<u> </u>

Register of Deeds Stamp & File Number

4. Lot No. _____, Recorded Plat _____
5. Private Claims _____

I, Randal D. Feenstra, in a field survey on August 19, 19 98 do hereby state that under requirements of P.A. 74, Michigan P.A. of 1970, the corner points mentioned in lines 1 and 2 above were in conformance with regulations and rules therefore as required in the current manual of survey instructions of the United States Department of the Interior, Bureau of Land Management or by a decree of a Court of Law and /or that the corner points mentioned in lines 3, 4 and 5 above were in conformance with the rules of the Michigan Board of Land Surveyors or by a Decree of a Court of Law; established, re-established, monumented, recovered, found as expressed below:

NOTE: Not more than 2 corners, all in the same town and range, may be recorded on this certificate.

1	A	B	C	D	E	F	G	H	I	J	K	L	M
2		6		5		4		3		2		1	
3													
4		7		8		9		10		11		12	
5													
6		18		17		16		15		14		13	
7													
8		19		20		21		22		23		24	
9													
10		30		29		28		27		26		25	
11													
12		31		32		33		34		35		36	
13													

A. Description of original monument and accessories and/or subsequent restoration:

G.L.O. (1838)	Liber 5, Page 250 (1986) (JOINER)
Rasselus Whitcomb	Set CIM
12" Sugar S52 1/2°W 12 1/2 lks.	Cut "X" on 12" Conc. Culv. WSW 16.55'
14" Beech S32° 1/2 E 33 lks.	Cut "X" on 12" Conc. Culv. NW 22.33'
	8" Tree E 42.48
	4" Maple SE 65.62

B. Description of corner evidence found and/or method applied in restoring or reestablishing corner:

No previous witnesses found (road recently rebuilt)
Found: Capped Rerod 0.36°W & 0.89S of a point 1/2 way between and on the line of K-11 & K-13 0.25' below bit. Road surface.
On tree/brush/fence row ± to East
Accepted as a careful and faithful perpetuation of the position of the original corner.

C. Description of monument for corner and accessories established to perpetuate locating the position of the corner:

Set Ottawa County Remon Bar and Cap in New Monument Box	
Set Ottawa County Remon Nail & Tag in S end 12" CMP Culvert	AZ 49°10' 34.79'
Set Ottawa County Remon Nail & Tag in S end 12" CMP Culvert	AZ 265°45' 25.45'
Set Ottawa County Remon Nail & Tag in N end 12" CMP Culvert	AZ 317°55' 37.32'
Set Ottawa County Remon Nail & Tag in S side 8" Tree	AZ 104°15' 37.51'
On CL N-S Bit. Rd. (8th Ave.)	
On Tree/Brush Line to East	

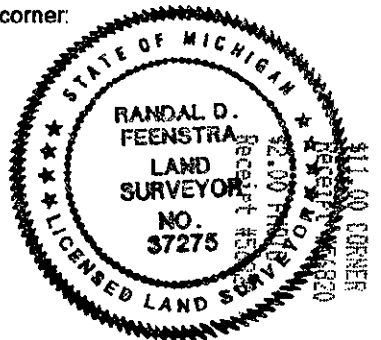

Signed by Randal D. Feenstra
Surveyor's Michigan License No. 37275

Date October 16, 1998

RECEIVED
FEB 24 2000

FEB 24 2000

SECTION

