

SURVEY & REMONUMENTATION

OCT 24 1994

COMMISSION

**OTTAWA COUNTY REMONUMENTATION
LAND CORNER RECORDATION CERTIFICATE
Filing Requirement of Act 74, Mich. P.A. 1970**

RECORDED

94 OCT -7 PH 12: 34

D. Lyell Chalmers
REGISTER OF DEEDS
OTTAWA COUNTY, MI

For corners in

Ottawa

(County)

Located In:

Corner Code #

1. Public Land Survey	T <u>9N</u> R <u>13W</u>	K- <u>13</u> , SE COR
	T _____ R _____	Sec. <u>35</u> , Chester
	T _____ R _____	_____
	T _____ R _____	_____
2. Property Controlling in Section	S _____ T _____ R _____	_____
	S _____ T _____ R _____	_____
3. Miscellaneous Property in Sec.	S _____ T _____ R _____	_____
	S _____ T _____ R _____	_____

Register of Deeds Stamp & File Number

4. Lot No. _____, Recorded Plat _____
5. Private Claims _____

	A	B	C	D	E	F	G	H	I	J	K	L	M
2	6	5	4	3	2	1							
3													
4	7	8	9	10	11	12							
5													
6	18	17	16	15	14	13							
7													
8	19	20	21	22	23	24							
9													
10	30	29	28	27	26	25							
11													
12	31	32	33	34	35	36							
13													

I, Randal D. Feenstra in a field survey on May 20, 19 94, do hereby certify that under requirements of P.A. 74, Michigan P.A. of 1970, the corner points mentioned in lines 1 and 2 above were in conformance with regulations and rules therefore as required in the current manual of survey instructions of the United States Department of the Interior, Bureau of Land Management or by a decree of a Court of Law and/or that the corner points mentioned in lines 3, 4 and 5 above were in conformance with the rules of the Michigan Board of Land Surveyors or by a Decree of a Court of Law; established, re-established, monumented, re-monumented, recovered, found as expressed below:

NOTE: Not more than 4 corners, all in the same town and range, may be recorded on this certificate.

A. Description of original monument and accessories and/or subsequent restoration:

G.L.O. (1838) Liber 5, Page 258 (1886)
Cor @ 18" Sugar C.I.M.
Wright Twp. Cor. E 42.90
Rasselas Whitcomb PP. NE 70.65
PP. SE 154.94
CL Street Sign 30.72

B. Description of corner evidence found and/or method applied in restoring or reestablishing corner:

Found: C.I.M. in Box - accepted as a careful and faithful perpetuation of the position of the original corner.

Found Witnesses:

Nail & tag in NW side PP	NE	70.65
Pk. in NW side PP	NE	70.65
Nail & tag in N side PP	SSE	154.96
Pk in W side PP	SSE	154.75
Wright Twp. Corner	E	42.85

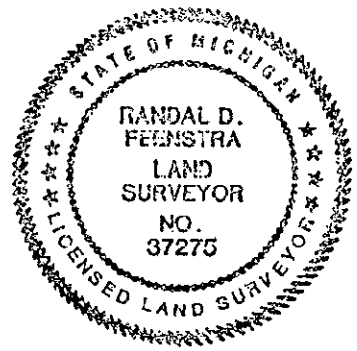

C. Description of monument for corner and accessories established to perpetuate locating the position of the corner:

(-13 Cast Iron Mon. in Box
).C. Remon. Nail & tag in NW side PP N45°E 70.66
).C. Remon. Nail & tag in SE Cor Plastic pad under tele. ped. N45°W 49.69
).C. Remon. Nail & tag in W side PP S30°E 154.79
"X" in W end 12" conc. Culv. N20°W 165.77
Wright Twp. Cor N90°E 42.85
On CL "X" Wilson and 8th Avenue North

RA. 345 OTTAWA COUNTY

PEER APPROVED 8/22/94

Gordon P. Medwell

Signed by

Randal D. Feenstra

Date

May 20, 1994

Surveyor's Michigan License No. 37275