

# SURVEY & REMONUMENTATION

APR 24 1995

COMMISSION

## OTTAWA COUNTY REMONUMENTATION LAND CORNER RECORDATION CERTIFICATE Filing Requirement of Act 74, Mich. P.A. 1970

RECORDED

94 DEC 15 AM 11:47

*Dorothy Redman*  
REGISTER OF DEEDS  
OTTAWA COUNTY, MI

For corners in

Ottawa  
(County)

Located In:

Corner Code #

- |                                    |                          |                        |
|------------------------------------|--------------------------|------------------------|
| 1. Public Land Survey              | T <u>9N</u> R <u>13W</u> | <u>L-5, S 1/4 Cor.</u> |
|                                    | T _____ R _____          | <u>Sec. 12</u>         |
|                                    | T _____ R _____          | <u>Chester Twp.</u>    |
|                                    | T _____ R _____          | _____                  |
| 2. Property Controlling in Section | S _____ T _____ R _____  | _____                  |
|                                    | S _____ T _____ R _____  | _____                  |
| 3. Miscellaneous Property in Sec.  | S _____ T _____ R _____  | _____                  |
|                                    | S _____ T _____ R _____  | _____                  |

Register of Deeds Stamp & File Number

4. Lot No. \_\_\_\_\_, Recorded Plat \_\_\_\_\_  
5. Private Claims \_\_\_\_\_

I, Randal D. Feenstra, in a field survey on December 8, 1994, do hereby certify that under requirements of P.A. 74, Michigan P.A. of 1970, the corner points mentioned in lines 1 and 2 above were in conformance with regulations and rules therefore as required in the current manual of survey instructions of the United States Department of the Interior, Bureau of Land Management or by a decree of a Court of Law and/or that the corner points mentioned in lines 3, 4 and 5 above were in conformance with the rules of the Michigan Board of Land Surveyors or by a Decree of a Court of Law; established, re-established, monumented, re-monumented, recovered, found as expressed below:

	A	B	C	D	E	F	G	H	I	J	K	L	M
2	6	5	4	3	2	1							
3													
4	7	8	9	10	11	12							
5													
6	18	17	16	15	14	13							
7													
8	19	20	21	22	23	24							
9													
10	30	29	28	27	26	25							
11													
12	31	32	33	34	35	36							
13													

**NOTE: Not more than 4 corners, all in the same town and range, may be recorded on this certificate.**

A. Description of original monument and accessories and/or subsequent restoration:

G.L.O. by Rasselas Whitcomb	L-3, P-254 (1977)
Sept. 17, 1838	C.I.M.
POST	"T" Iron N03 E 33.00'
30" Beech N05 W 16 links	P.Pole N76 E 108.08'
12" Beech S32 W 16 links	24" Maple S74 E 55.65'
	NW Hse. Cor. S50 E 189.47'

B. Description of corner evidence found and/or method applied in restoring or reestablishing corner:

Found: C.I.M. in box and is accepted as a careful and faithful perpetuation of the position of the original corner.

NW Hse cor. SE 189.45'

PA. 345 OTTAWA COUNTY  
PEER APPROVED 12/12/94  
*Harold P. Redwood*

C. Description of monument for corner and accessories established to perpetuate locating the position of the corner:

C-5 C.I.M. in Box	
O.C. Remon Nail & Tag in SW side P. Pole	S45 E 85.48'
O.C. Remon. Nail & Tag in S side fence Post	N45 W 53.59'
O.C. Remon. Nail & Tag in E side fence Post	N10 E 34.11'
O.C. Remon Nail & Tag in E end 12" CSP	N20 W 30.21'

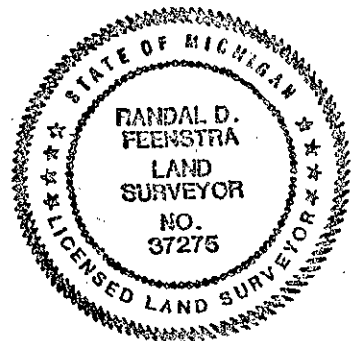

Signed by Randal D. Feenstra

Date December 8, 1994

Surveyor's Michigan License No. 37275

FORM APPROVED BY MICHIGAN STATE BOARD OF LAND SURVEYORS, JAN. 28, 1971  
REVISED MAY 14, 1975  
REVISED JAN., 1983