

**SURVEY &
REMONUMENTATION**

APR 05 1996

OTTAWA COUNTY REMONUMENTATION

LAND CORNER RECORDATION CERTIFICATE
Filing Requirement of Act 74, Mich. P.A. 1970

COMMISSION

For corners in
Ottawa
(County)

Located In:	Corner Code #
Chester Twp. 9N 13W	L-9, S 1/4 cor. Sec. 24
T___ R___	_____
T___ R___	_____
T___ R___	_____
T___ R___	_____
S___ T___ R___	_____
S___ T___ R___	_____
S___ T___ R___	_____
S___ T___ R___	_____

- Public Land Survey
- Property Controlling in Section
- Miscellaneous Property in Sec.

RECORDED

95 NOV 29 PM 1:35

D. J. ...
REGISTER OF DEEDS
OTTAWA COUNTY, MI

Register of Deeds Stamp & File Number

- Lot No. _____, Recorded Plat _____
- Private Claims _____

I, Randal D. Feenstra, in a field survey on Nov 6, 1995 do hereby state that under requirements of P.A. 74, Michigan P.A. of 1970, the corner points mentioned in lines 1 and 2 above were in conformance with regulations and rules therefore as required in the current manual of survey instructions of the United States Department of the Interior, Bureau of Land Management or by a decree of a Court of Law and/or that the corner points mentioned in lines 3, 4 and 5 above were in conformance with the rules of the Michigan Board of Land Surveyors or by a Decree of a Court of Law; established, re-established, monumented, recovered, found as expressed below:

	A	B	C	D	E	F	G	H	I	J	K	L	M
1													
2	6	5	4	3	2	1							
3													
4	7	8	9	10	11	12							
5													
6	18	17	16	15	14	13							
7													
8	19	20	21	22	23	24							
9													
10	30	29	28	27	26	25							
11													
12	31	32	33	34	35	36							
13													

NOTE: Not more than 2 corners, all in the same town and range, may be recorded on this certificate.

A. Description of original monument and accessories and/or subsequent restoration:

G.L.O. (1838)	L-3, P-125, (1976)	L-6, P-211 (1991)
Rasselas Witcomb	1/2" Iron	G & A Capped 1/2" Iron
28" Cherry S39°W 16 lks.	18" Maple WNW 150.46'	30" Maple N75°W 288.28'
20" Sugar N89°E 20 lks	3" Apple SW 54.04'	8" Apple S71°W 68.02'
	3" Apple S 45.94'	SE Cor. Hse. #467 N66°W 291.50'
		P. Pole N56°E 267.15'

B. Description of corner evidence found and/or method applied in restoring or reestablishing corner:

Found: 1/2" rebar Accepted as a careful and faithful perpetuation of the position of the original corner.

SE Cor. Hse. #467 N66°W 291.58' P.A. 345 OTTAWA COUNTY
Fnd. Nail S Side 30" Maple 288.26' PEER APPROVED 11/20/95

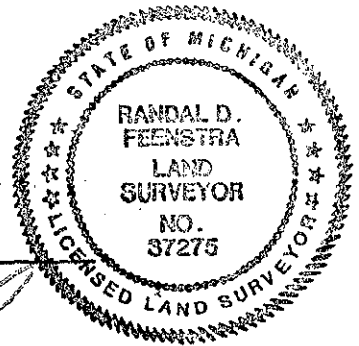

Randal D. Feenstra

C. Description of monument for corner and accessories established to perpetuate locating the position of the corner:

L-9	Set Ottawa County Remon. Bar & Cap in box	S19°W	67.99'
	Set Ottawa County Remon Nail & Tag W side 8" Apple	N67°W	291.58'
	SE Cor. Hse. #467	S78°E	493.85'
	NW Cor. Garage Foundation	N	33.03'
	Capped Iron		

Centerline Coolidge St. (Bit Road) 2' North

Signed by *Randal D. Feenstra*
Surveyor's Michigan License No. 37275

Date November 6, 1995