

SURVEY & REMONUMENTATION

OCT 24 1994

COMMISSION

OTTAWA COUNTY REMONUMENTATION

LAND CORNER RECORDATION CERTIFICATE

Filing Requirement of Act 74, Mich. P.A. 1970

RECORDED

94 OCT -7 PM 12:34

R. J. ...
REGISTER OF DEEDS
OTTAWA COUNTY, MI

For corners in

<u>Ottawa</u> (County)	Located In:	Corner Code #
1. Public Land Survey	T 9N R 13W	L-11, N 1/4 COR
	T R	Sec. 36, Chester
	T R	
	T R	
2. Property Controlling in Section	S T R	
	S T R	
3. Miscellaneous Property in Sec.	S T R	
	S T R	
4. Lot No. _____, Recorded Plat _____		
5. Private Claims _____		

Register of Deeds Stamp & File Number

A	B	C	D	E	F	G	H	I	J	K	L	M
2	6	5	4	3	2	1						
3												
4	7	8	9	10	11	12						
5												
6	18	17	16	15	14	13						
7												
8	19	20	21	22	23	24						
9												
10	30	29	28	27	26	25						
11												
12	31	32	33	34	35	36						
13												

I, Randal D. Feenstra in a field survey on May 20, 19 94, do hereby certify that under requirements of P.A. 74, Michigan P.A. of 1970, the corner points mentioned in lines 1 and 2 above were in conformance with regulations and rules therefore as required in the current manual of survey instructions of the United States Department of the Interior, Bureau of Land Management or by a decree of a Court of Law and/or that the corner points mentioned in lines 3, 4 and 5 above were in conformance with the rules of the Michigan Board of Land Surveyors or by a Decree of a Court of Law; established, re-established, monumented, re-monumented, recovered, found as expressed below:

NOTE: Not more than 4 corners, all in the same town and range, may be recorded on this certificate.

A. Description of original monument and accessories and/or subsequent restoration:

L.O. (1838)	Liber 3, Pg. 124 (1976)	Liber 5, Pg. 250 (1986)
3/8" Re-rod		
~ Sugar N3.5°W 21.1	Pk. in PP N 40.58	C.I.M.
~ Beech S19°E 18.5	Pk in PP WSW 41.53	PP N 40.68
ST	NE in cor hse SE 96.91	6" Maple SE 72.97
sselas Whitcomb		NW Cor Hse SSE 77.67
		PP SSW 41.51

B. Description of corner evidence found and/or method applied in restoring or reestablishing corner:

Found: C.I.M. in Box (No Cover) - accepted as a careful and faithful perpetuation of the position of the original corner.

Found Witnesses:

Nail & tag in E side PP	N 40.63
Pk in E side PP	N 40.61
Nail & tag in E side PP	SSW 41.42
Pk in W side PP	SSW 41.51
NW Cor of Hse	SSE 77.53

P.A. 345 OTTAWA COUNTY

PEER APPROVED 9/23/94

Rodney P. Hedewell

C. Description of monument for corner and accessories established to perpetuate locating the position of the corner:

-11 C.I.M. in Box	
C. Remon. Nail & tag in E side PP	N00°E 40.62
C. Remon. Nail & tag in E side PP	S30°W 41.42
C. Remon. Nail & tag in NE side 10" Crab Apple	S15°E 70.39
C. Remon. Nail & tag in NE side 10" Maple	S55°E 73.13

in CL Harding Street, Fence line to North.

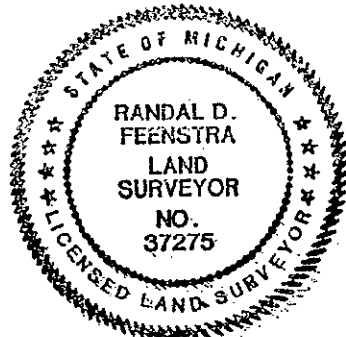

Signed by Randal D. Feenstra

Date May 20, 1994

Surveyor's Michigan License No. 37275