

SURVEY & REMONUMENTATION

OCT 24 1994

COMMISSION

**OTTAWA COUNTY REMONUMENTATION
LAND CORNER RECORDATION CERTIFICATE
Filing Requirement of Act 74, Mich. P.A. 1970**

RECORDED
94 OCT -7 PM 12:34

Ralph A. Coleman
REGISTER OF DEEDS
OTTAWA COUNTY, MI

For corners in

Ottawa (County)	Located In:	Corner Code #
1. Public Land Survey	T 9N R 13W	L-13, S 14 COR Sec. 36, Chester
	T ___ R ___	_____
	T ___ R ___	_____
	T ___ R ___	_____
2. Property Controlling in Section	S ___ T ___ R ___	_____
	S ___ T ___ R ___	_____
3. Miscellaneous Property in Sec.	S ___ T ___ R ___	_____
	S ___ T ___ R ___	_____
4. Lot No. _____, Recorded Plat _____		
5. Private Claims _____		

Register of Deeds Stamp & File Number

I, Randal D. Feenstra in a field survey on May 20, 19 94, do hereby certify that under requirements of P.A. 74, Michigan P.A. of 1970, the corner points mentioned in lines 1 and 2 above were in conformance with regulations and rules therefore as required in the current manual of survey instructions of the United States Department of the Interior, Bureau of Land Management or by a decree of a Court of Law and/or that the corner points mentioned in lines 3, 4 and 5 above were in conformance with the rules of the Michigan Board of Land Surveyors or by a Decree of a Court of Law; established, re-established, monumented, re-monumented, recovered, found as expressed below:

NOTE: Not more than 4 corners, all in the same town and range, may be recorded on this certificate.

A. Description of original monument and accessories and/or subsequent restoration:

.L.O. (1838)	Liber 5, Page 318 (1988)
3" Beech N58°W 11.2	
3" Tree N58°E 5.9	C.I.M.
OST	16" Apple S 92.00
asselas Whitcomb	12" Apple SW 92.58
	24" Apple NE 32.69
	Wright Twp. Cor. E 21.60

B. Description of corner evidence found and/or method applied in restoring or reestablishing corner:

Found: C.I.M. in Box (No Cover) - accepted as a careful and faithful perpetuation of the position of the original corner.
Found Witnesses:
Wright Twp. Cor E 21.59

C. Description of monument for corner and accessories established to perpetuate locating the position of the corner:

-13 C.I.M. in Box	
.C. Remon. Nail & tag in S side 24" Apple	N55°E 66.22
.C. Remon. Nail & tag in S Side 22" Apple	N55°W 65.67
12" in W end 12" conc. culv.	S10°W 30.13
12" in E end 12" conc. culv.	S50°E 43.46
Wright Twp. Cor.	N90°E 21.59
3' N of CL Wilson Street and 16' W of Gr. Dr. to S.	

	A	B	C	D	E	F	G	H	I	J	K	L	M
2	6	5	4	3	2	1							
3													
4	7	8	9	10	11	12							
5													
6	18	17	16	15	14	13							
7													
8	19	20	21	22	23	24							
9													
10	30	29	28	27	26	25							
11													
12	31	32	33	34	35	36							
13													

P.A. 345 OTTAWA COUNTY
PEER APPROVED 9/22/94

Gordon D. Nedwell

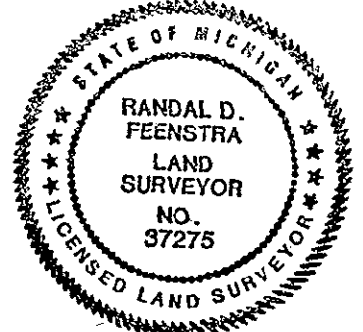

Signed by Randal D. Feenstra Date May 20, 1994
Surveyor's Michigan License No. 37275