

OTTAWA COUNTY REMONUMENTATION

LAND CORNER RECORDATION CERTIFICATE
 Filing Requirement of Act 74, Mich. P.A. 1970

10000 200

For corners in

<u>Ottawa</u> (County)	Located In:	Corner Code #
	Chester Twp.	
1. Public Land Survey	T <u>9</u> N R <u>13</u> W	M-3 NE cor.
	T ___ R ___	Sec. <u>12</u>
	T ___ R ___	
	T ___ R ___	
2. Property Controlling in Section	S ___ T ___ R ___	
	S ___ T ___ R ___	
3. Miscellaneous Property in Sec.	S ___ T ___ R ___	
	S ___ T ___ R ___	

RECORDED

96 DEC 17 AM 10:42

Ralphie Childman
 REGISTER OF DEEDS,
 OTTAWA COUNTY, MI

Register of Deeds Stamp & File Number

4. Lot No. _____, Recorded Plat _____
 5. Private Claims _____

I, Randal D. Feenstra, in a field survey on Oct 24, 1996 do hereby state that under requirements of P.A. 74, Michigan P.A. of 1970, the corner points mentioned in lines 1 and 2 above were in conformance with regulations and rules therefore as required in the current manual of survey instructions of the United States Department of the Interior, Bureau of Land Management or by a decree of a Court of Law and/or that the corner points mentioned in lines 3, 4 and 5 above were in conformance with the rules of the Michigan Board of Land Surveyors or by a Decree of a Court of Law; established, re-established, monumented, recovered, found as expressed below:

NOTE: Not more than 2 corners, all in the same town and range, may be recorded on this certificate.

1	A	B	C	D	E	F	G	H	I	J	K	L	M
2		6		5		4		3		2		1	
3													
4		7		8		9		10		11		12	
5													
6		10		17		16		15		14		13	
7													
8		19		20		21		22		23		24	
9													
10		30		29		28		27		26		25	
11													
12		31		32		33		34		35		36	
13													

A. Description of original monument and accessories and/or subsequent restoration:

G.L.O. (1837) Noah Brookfield Post 10" Beech N89° 30'W 28 lks 8" Beech S6°W 28 lks	L-5, P-12, 1982 Monument Box MBT N45°W 63.2' C.P. S30°W 71.73' MBT S20°E 60.75 MBT N40°E 76.0'	L-5, P-163, 1984 Cast Iron Monument 12" Apple NW 65.13' P. Pole SW 80.95' Guard Post SE 71.84' St. Sign NE 43.07'	Kent County, LCRC #3607 Cast Iron Monument Nail in W side 8" Beech N23E 101.35' Nail in NE side P. Pole S60E 167.75' Nail in E side P. Pole S27W 80.89' Nail in SW side 12" Apple N48W 65.10' Nail in E side 15" Spruce N8W 224.51'
--	---	--	---

B. Description of corner evidence found and/or method applied in restoring or reestablishing corner:

M-3 Found: PK with Tag

Row Iron	WSW	121.14'	(255°02'54")
Row Iron	SSW	121.11'	(196°00'10")
P. Pole	S62°E	167.22'	

Accepted as a careful and faithful perpetuation of the position of the original corner

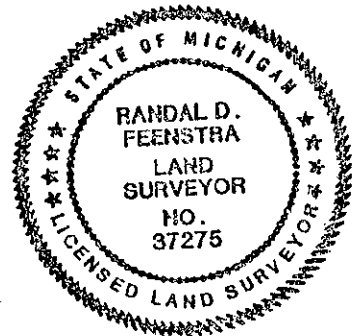

C. Description of monument for corner and accessories established to perpetuate locating the position of the corner:

M-3 Set Ottawa County Remon Bar and Cap in New Monument Box

Ottawa County Remon Nail and Tag in N side P. Pole	S 62°E	167.22'
Ottawa County Remon Nail and Tag in S side 16" Apple	N 64°W	144.63'
Ottawa County Remon Nail and Tag in N side P. Pole	S 57°W	128.67'
Ottawa County Remon Nail and Tag in E side 14" Pine	N 16°W	228.71'
Ottawa County Remon Nail and Tag in S side P. Pole	N 51°E	195.25'
"X" in W ed 12" Conc. Culvert	N 47°W	63.89'
Centerline Kenowa	0.5'E	
Centerline Truman	0.5'N	

P.A. 345 OTTAWA COUNTY
 PEER APPROVED 11-11-96

R.D.F.

\$ 9.00 CORNER
 \$ 1.00 PHOTO

Signed by Randal D. Feenstra
 Surveyor's Michigan License No. 37275

Date October 7, 1996