

**SURVEY & REMONUMENTATION**

APR 24 1995

**OTTAWA COUNTY REMONUMENTATION  
LAND CORNER RECORDATION CERTIFICATE  
Filing Requirement of Act 74, Mich. P.A. 1970**

RECORDED

94 DEC 15 AM 11:47

For corners in  
**COMMISSION**  
Ottawa  
(County)

*D. J. ...*  
REGISTER OF DEEDS  
OTTAWA COUNTY, MI

	Located In:	Corner Code #
1. Public Land Survey	T <u>9N</u> R <u>13W</u>	M-4, E 1/4 Cor.
	T _____ R _____	Sec. 12
	T _____ R _____	Chester Twp.
	T _____ R _____	
2. Property Controlling in Section	S _____ T _____ R _____	
	S _____ T _____ R _____	
3. Miscellaneous Property in Sec.	S _____ T _____ R _____	
	S _____ T _____ R _____	
4. Lot No. _____, Recorded Plat _____		
5. Private Claims _____		

Register of Deeds Stamp & File Number

A	B	C	D	E	F	G	H	I	J	K	L	M
2	6	5	4	3	2	1						
3												
4	7	8	9	10	11	12						
5												
6	18	17	16	15	14	13						
7												
8	19	20	21	22	23	24						
9												
10	30	29	28	27	26	25						
11												
12	31	32	33	34	35	36						
13												

I, Randal D. Feenstra, in a field survey on December 8, 1994, do hereby certify that under requirements of P.A. 74, Michigan P.A. of 1970, the corner points mentioned in lines 1 and 2 above were in conformance with regulations and rules therefore as required in the current manual of survey instructions of the United States Department of the Interior, Bureau of Land Management or by a decree of a Court of Law and/or that the corner points mentioned in lines 3, 4 and 5 above were in conformance with the rules of the Michigan Board of Land Surveyors or by a Decree of a Court of Law; established, re-established, monumented, re-monumented, recovered, found as expressed below:

**NOTE: Not more than 4 corners, all in the same town and range, may be recorded on this certificate.**

A. Description of original monument and accessories and/or subsequent restoration:  
 G.L.O. by Noah Brookfield L-3,P-253 (1977) L-6,P-79 (1990)  
 Jun 5, 1837 "T" Iron Kent County Corner  
 POST 18" Apple S56 E 110.6' P. Pole NE 135.70  
 9" Beech S62 W 9 links 30" Maple S32 W 78.15' 26" Apple SE 110.28  
 9" Beech N16 W 7 links 20" Maple S77 W 36.78' 11" Apple SSE 143.13

B. Description of corner evidence found and/or method applied in restoring or reestablishing corner:  
 Found: C.I.M. in box and is accepted as a careful and faithful perpetuation of the position of the original corner.

Nail in S side P. Pole NE 135.67'  
 Nail in S side 26" Apple SE 110.21'

P.A. 345 OTTAWA COUNTY  
 PEER APPROVED 12/12/94  
*Randolph P. Nedeweld*

C. Description of monument for corner and accessories established to perpetuate locating the position of the corner:

M-4 C.I.M. in Box  
 O.C. Remon. Nail & Tag in S Side P. Pole N60 E 168.97'  
 O.C. Remon. Nail & Tag in W side 26" Apple S60 E 109.44'  
 O.C. Remon Nail & Tag in W side Sign Post S25 E 69.62'  
 "X" in N end 18" conc. culv. N60 E 50.79'  
 2' E and 5' S of CL "X" Kenowa and Lutheran Church

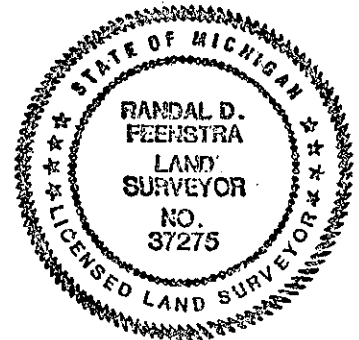

Signed by *Randal D. Feenstra*  
 Randal D. Feenstra

Date December 8, 1994

Surveyor's Michigan License No. 37275