

SURVEY & REMONUMENTATION

APR 24 1995

COMMISSION

For corners in
Ottawa

**OTTAWA COUNTY REMONUMENTATION
LAND CORNER RECORDATION CERTIFICATE
Filing Requirement of Act 74, Mich. P.A. 1970**

RECORDED

94 DEC 15 AM 11:47

Reggie Holloman
REGISTER OF DEEDS
OTTAWA COUNTY, MI

For corners in Ottawa (County)	Located In:	Corner Code #
1. Public Land Survey	T ^{9N} R ^{13W}	M-5, SE Cor.
	T _____ R _____	Sec. 12
	T _____ R _____	Chester Twp.
	T _____ R _____	
2. Property Controlling in Section	S _____ T _____ R _____	
	S _____ T _____ R _____	
3. Miscellaneous Property in Sec.	S _____ T _____ R _____	
	S _____ T _____ R _____	
4. Lot No. _____, Recorded Plat _____		
5. Private Claims _____		

Register of Deeds Stamp & File Number

	A	B	C	D	E	F	G	H	I	J	K	L	M
2	6	5	4	3	2	1							
3													
4	7	8	9	10	11	12							
5													
6	18	17	16	15	14	13							
7													
8	19	20	21	22	23	24							
9													
10	30	29	28	27	26	25							
11													
12	31	32	33	34	35	36							
13													

I, Randal D. Feenstra, in a field survey on December 8, 1994, do hereby certify that under requirements of P.A. 74, Michigan P.A. of 1970, the corner points mentioned in lines 1 and 2 above were in conformance with regulations and rules therefore as required in the current manual of survey instructions of the United States Department of the Interior, Bureau of Land Management or by a decree of a Court of Law and/or that the corner points mentioned in lines 3, 4 and 5 above were in conformance with the rules of the Michigan Board of Land Surveyors or by a Decree of a Court of Law; established, re-established, monumented, re-monumented, recovered, found as expressed below:

NOTE: Not more than 4 corners, all in the same town and range, may be recorded on this certificate.

A. Description of original monument and accessories and/or subsequent restoration:
 G.L.O. by Noah Brookfield L-5, P-139 (1983)
 June 5, 1837 C.I.M.
 POST 15" Apple NW 72.30'
 12" Beech N70 W 13 links CL St. Sign SW 46.15'
 10" Beech S03 W 32 links P. Pole NE 100.09'
 P. Pole SE 74.55'

B. Description of corner evidence found and/or method applied in restoring or reestablishing corner:
 Found: C.I.M. in box and is accepted as a careful and faithful perpetuation of the position of the original corner.

Nail in E side 16" Apple NW 72.25'
 Pk in N side P. Pole NE 100.03'

C. Description of monument for corner and accessories established to perpetuate locating the position of the corner:

M-5 C.I.M. in Box
 O.C. Remon Nail & Tag in E side 16" Apple N45 W 72.04'
 O.C. Remon. Nail & Tag in E side 12" Apple N30 W 103.84'
 O.C. Remon. Nail & Tag in S side P. Pole N50 E 99.97'
 O.C. Remon Nail & Tag in N side P. Pole S55 E 74.88'
 On CL "X" Kenowa and Hoover

P.A. 345 OTTAWA COUNTY
 PEER APPROVED 12/12/94
Randy D. Nedewell

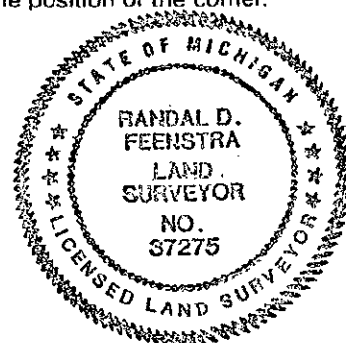

Signed by *Randal D. Feenstra*
 Randal D. Feenstra

Date December 8, 1994

Surveyor's Michigan License No. 37275