

SURVEY &
REMONUMENTATION

APR 05 1996

OTTAWA COUNTY REMONUMENTATION

COMMISSION

LAND CORNER RECORDATION CERTIFICATE
Filing Requirement of Act 74, Mich. P.A. 1970

For corners in
Ottawa

RECORDED

95 NOV 29 PM 1:35

Phyllis Callahan
REGISTER OF DEEDS
OTTAWA COUNTY, MI

Located In:	Corner Code #
Chester Twp. 9N 13W	M-7, NE cor.
T <u> </u> R <u> </u>	Sec. 24
T <u> </u> R <u> </u>	
T <u> </u> R <u> </u>	
T <u> </u> R <u> </u>	
S <u> </u> T <u> </u> R <u> </u>	
S <u> </u> T <u> </u> R <u> </u>	
S <u> </u> T <u> </u> R <u> </u>	
S <u> </u> T <u> </u> R <u> </u>	

Register of Deeds Stamp & File Number

4. Lot No. _____, Recorded Plat _____
5. Private Claims _____

I, Randal D. Feenstra, in a field survey on Nov 6, 1995 do hereby state that under requirements of P.A. 74, Michigan P.A. of 1970, the corner points mentioned in lines 1 and 2 above were in conformance with regulations and rules therefore as required in the current manual of survey instructions of the United States Department of the Interior, Bureau of Land Management or by a decree of a Court of Law and /or that the corner points mentioned in lines 3, 4 and 5 above were in conformance with the rules of the Michigan Board of Land Surveyors or by a Decree of a Court of Law; established, re-established, monumented, recovered, found as expressed below:

NOTE: Not more than 2 corners, all in the same town and range, may be recorded on this certificate.

	A	B	C	D	E	F	G	H	I	J	K	L	M
1													
2	6		5		4		3		2		1		
3													
4	7		8		9		10		11		12		
5													
6	16		17		16		15		14		13		
7													
8	19		20		21		22		23		24		
9													
10	30		29		28		27		26		25		
11													
12	31		32		33		34		35		36		
13													

A. Description of original monument and accessories and/or subsequent restoration:

G.L.O. (1837)	L-3, P-171, (1977)	L-5, P-111 (1984)
Noah Brookfield	Iron in Mon. Box	C.I.M.
18" Beech S 8°W 60 lks.	P. Pole N45°E 56.27'	Centerline St. Sign SW 39.73'
12" Beech N0.5°W 43 lks	P. Pole S55°E 53.80	NW Cor. Hse. Fndn SE 70.65'
	SE Cor. Brick Hse. N36°W 144.18'	P. Pole SE 53.92'
		P. Pole NE 56.31'

B. Description of corner evidence found and/or method applied in restoring or reestablishing corner:

Found: C.I.M. in box Accepted as a careful and faithful perpetuation of the position of the original corner.

NW Cor. Fndn. to Hse. #10790 SE 70.55'

Pk. in W side of P. Pole NE 56.27'

RA. 345 OTTAWA COUNTY

PEER APPROVED 11/20/95

Kendall D. Redwood
RD 7

C. Description of monument for corner and accessories established to perpetuate locating the position of the corner:

m-7	C.I.M. in box		
M-6	Ottawa County Remon Nail & Tag in W side P. Pole	32°	56.41'
	Ottawa County Remon Nail & Tag in side P. Pole	123°	54.64'
	Ottawa County Remon. Nail and Tag in SW side 8" Birch	321°	86.70'
	NW Cor. Fndn. to Hse. #10790	145°	70.55'

2.5' S of centerline "X" Kenowa Ave. and Gooding St.

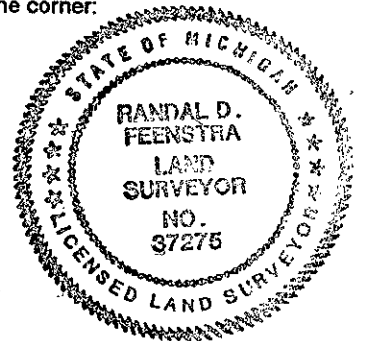

Signed by Randal D. Feenstra
Surveyor's Michigan License No. 37275

Date November 6, 1995