

APR 05 1996

OTTAWA COUNTY REMONUMENTATION

COMMISSION

LAND CORNER RECORDATION CERTIFICATE  
Filing Requirement of Act 74, Mich. P.A. 1970

For corners in  
Ottawa

Located in:	Corner Code #
Chester Twp. 9N 13W	M-8, E 1/4 cor. Sec. 24
T ___ R ___	_____
T ___ R ___	_____
T ___ R ___	_____
T ___ R ___	_____
S ___ T ___ R ___	_____
S ___ T ___ R ___	_____
S ___ T ___ R ___	_____
S ___ T ___ R ___	_____

1. Public Land Survey

2. Property Controlling in Section

3. Miscellaneous Property in Sec.

4. Lot No. \_\_\_\_\_, Recorded Plat \_\_\_\_\_  
5. Private Claims \_\_\_\_\_

I, Randal D. Feenstra, in a field survey on Nov 6, 19 95 do hereby state that under requirements of P.A. 74, Michigan P.A. of 1970, the corner points mentioned in lines 1 and 2 above were in conformance with regulations and rules therefore as required in the current manual of survey instructions of the United States Department of the Interior, Bureau of Land Management or by a decree of a Court of Law and /or that the corner points mentioned in lines 3, 4 and 5 above were in conformance with the rules of the Michigan Board of Land Surveyors or by a Decree of a Court of Law; established, re-established, monumented, recovered, found as expressed below:

NOTE: Not more than 2 corners, all in the same town and range, may be recorded on this certificate.

RECORDED  
95 NOV 29 PM 1:35  
*Phyllis Hullman*  
REGISTER OF DEEDS  
OTTAWA COUNTY, MI

Register of Deeds Stamp & File Number

	A	B	C	D	E	F	G	H	I	J	K	L	M
1													
2	6		5		4		3		2		1		
3													
4	7		8		9		10		11		12		
5													
6	10		17		16		15		14		13		
7													
8	19		20		21		22		23		24		
9													
10	30		29		28		27		26		25		
11													
12	31		32		33		34		35		36		
13													

A. Description of original monument and accessories and/or subsequent restoration:

G.L.O. (1837) Noah Brookfield 8" Beech in corner	L-3, P-125, (1976) RR Spike "X" in culv. NNW 37.20' "X" in culv. NNE 45.01' 14" Apple SE 52.16'	L-5, P-139 (1984) C.I.M. 14" Apple SE 52.79' 14" Apple SSE 81.31' "X" in culv. NNW 37.20' "X" in culv. NNE 45.01'	L-5, P-238 (1986) Mon. Box "X" in N. end culv. N40°E 45.01' "X" in S. end culv. N45°W37.20' 14" Apple S60°E 52.16'
---	---	--	--

P.A. 345 OTTAWA COUNTY  
PEER APPROVED 11/20/95

B. Description of corner evidence found and/or method applied in restoring or reestablishing corner:

Found: C.I.M. in box Accepted as a careful and faithful perpetuation of the position of the original corner.  
"X" on N end 12" conc. culv. NE 45.01'  
"X" on S end 12" conc. culv. NW 37.09'  
Nail in SW side 14" Apple SE 52.13'  
Nail in N side 14" Apple SSE 81.28'

*Randal D. Feenstra*  
*LPV*

C. Description of monument for corner and accessories established to perpetuate locating the position of the corner:

M-8	C.I.M. in box		
	Ottawa County Remon Nail & Tag in SW side 14" Apple	125°	51.80'
	Ottawa County Remon Nail & Tag in N. side 14" Apple	147°	81.32'
	"X" on N end 12" conc. culv.	37°	45.01'
	"X" on S end 12" conc. culv.	315°	37.09'

0.5' W of centerline Kenowa Ave.

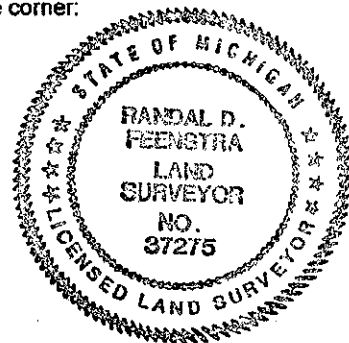

Signed by *Randal D. Feenstra*  
Surveyor's Michigan License No. 37275

Date November 6, 1995