

APR 05 1996

OTTAWA COUNTY REMONUMENTATION

COMMISSION

LAND CORNER RECORDATION CERTIFICATE
Filing Requirement of Act 74, Mich. P.A. 1970

For corners in
Ottawa

Located In:	Corner Code #
Chester Twp. 9N 13W M-9, NE cor.	
T R	Sec. 25
T R	
T R	
T R	
S T R	
S T R	
S T R	
S T R	

1. Public Land Survey

2. Property Controlling in Section

3. Miscellaneous Property in Sec.

RECORDED

95 NOV 29 PM 1:36

Ruthie Callman
REGISTER OF DEEDS
OTTAWA COUNTY, MI

Register of Deeds Stamp & File Number

4. Lot No. _____, Recorded Plat _____
5. Private Claims _____

I, Randal D. Feenstra, in a field survey on Nov 6, 1995 do hereby state that under requirements of P.A. 74, Michigan P.A. of 1970, the corner points mentioned in lines 1 and 2 above were in conformance with regulations and rules therefore as required in the current manual of survey instructions of the United States Department of the Interior, Bureau of Land Management or by a decree of a Court of Law and /or that the corner points mentioned in lines 3, 4 and 5 above were in conformance with the rules of the Michigan Board of Land Surveyors or by a Decree of a Court of Law; established, re-established, monumented, recovered, found as expressed below:

NOTE: Not more than 2 corners, all in the same town and range, may be recorded on this certificate.

	A	B	C	D	E	F	G	H	I	J	K	L	M
1													
2	6		5		4		3		2		1		
3													
4	7		8		9		10		11		12		
5													
6	18		17		16		15		14		13		
7													
8	19		20		21		22		23		24		
9													
10	30		29		28		27		26		25		
11													
12	31		32		33		34		35		36		
13													

A. Description of original monument and accessories and/or subsequent restoration:

G.L.O. (1837)	L-3, P-125, (1976)	L-5, P-111 (1984)
Noah Brookfield	Mon. Box	C.I.M.
24" Beech S20°W 75 lks.	48" Poplar WNW 99.65'	SW Cor. Gar. NW 53.70'
10" Beech N65°W 31 lks	SE Cor. Gar. NW 53.70'	L. Pole SE 54.67'
	P. Pole SE 49.60'	St. Sign SW 53.92'
		NE Cor. Gar. NW 56.31'

B. Description of corner evidence found and/or method applied in restoring or reestablishing corner:

Found: C.I.M. in box Accepted as a careful and faithful perpetuation of the position of the original corner.

SE Cor. Garage	NW 53.95'
NE Cor. Garage	NW 69.02'
Centerline St. Sign	SW 39.59'
Pk. in SW side of L. Pole	SE 40.51'

P.A. 345 OTTAWA COUNTY
PEER APPROVED 11/20/95

Randal D. Feenstra

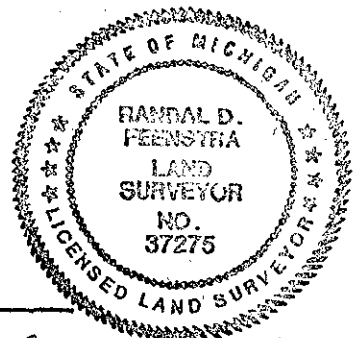

C. Description of monument for corner and accessories established to perpetuate locating the position of the corner:

M-9	C.I.M. in box		
	Ottawa County Remon Nail & Tag in SW side L. Pole	125°	40.52'
	SW Fndn. Cor. to Garage	300°	73.57'
	NW Cor. Fndn. to Garage	325°	69.02'
	Ottawa County Remon Nail & Tag in S. side 32" Oak	283°	130.97'

1.5' W of centerline "X" Kenowa Ave. and Coolidge St.

Signed by Randal D. Feenstra
Surveyor's Michigan License No. 37275

Date November 6, 1995