

SURVEY & REMONUMENTATION

OCT 24 1994

COMMISSION

**OTTAWA COUNTY REMONUMENTATION
LAND CORNER RECORDATION CERTIFICATE
Filing Requirement of Act 74, Mich. P.A. 1970**

RECORDED

94 OCT -7 PM 12:34

R. D. ...
REGISTER OF DEEDS
OTTAWA COUNTY, MI

For corners in

<u>Ottawa</u> (County)	Located In:	Corner Code \neq
1. Public Land Survey	T <u>9N</u> R <u>13W</u>	M-12, E 1/4 COR Sec. 36, Chester
	T _____ R _____	_____
	T _____ R _____	_____
	T _____ R _____	_____
2. Property Controlling in Section	S _____ T _____ R _____	_____
	S _____ T _____ R _____	_____
3. Miscellaneous Property in Sec.	S _____ T _____ R _____	_____
	S _____ T _____ R _____	_____
4. Lot No. _____, Recorded Plat _____		
5. Private Claims _____		

Register of Deeds Stamp & File Number

	A	B	C	D	E	F	G	H	I	J	K	L	M
2	6	5	4	3	2	1							
3													
4	7	8	9	10	11	12							
5													
6	18	17	16	15	14	13							
7													
8	19	20	21	22	23	24							
9													
10	30	29	28	27	26	25							
11													
12	31	32	33	34	35	36							
13													

I, Randal D. Feenstra, in a field survey on July 13, 1994, do hereby certify that under requirements of P.A. 74, Michigan P.A. of 1970, the corner points mentioned in lines 1 and 2 above were in conformance with regulations and rules therefore as required in the current manual of survey instructions of the United States Department of the Interior, Bureau of Land Management or by a decree of a Court of Law and/or that the corner points mentioned in lines 3, 4 and 5 above were in conformance with the rules of the Michigan Board of Land Surveyors or by a Decree of a Court of Law; established, re-established, monumented, re-monumented, recovered, found as expressed below:

NOTE: Not more than 4 corners, all in the same town and range, may be recorded on this certificate.

A. Description of original monument and accessories and/or subsequent restoration:
G.L.O. (1838) Liber 6, Page 104 (1991)
 10" Beech S80°W 7.9' C.I.M. (Kent County)
 10" Beech N32°W 26.4' 8" Apple SW 70.30
 POST 8" Apple NW 58.30
 Rasselas Whitcomb 26" Maple SSW 169.40

B. Description of corner evidence found and/or method applied in restoring or reestablishing corner:

Found: C.I.M. (Kent County) - accepted as a careful and faithful perpetuation of the position of the original corner.
 8" Apple SW 70.3 feet ± to tree, no nail.

P.A. 345 OTTAWA COUNTY

PEER APPROVED 8/22/94

Randal D. Feenstra

C. Description of monument for corner and accessories established to perpetuate locating the position of the corner:

M-11 C.I.M. (Kent County)
 O.C. Remon. Nail & tag in S side 8" Apple N45°W 71.45
 O.C. Remon. Nail & tag in S side 8" Apple N90°W 50.94
 O.C. Remon. Nail & tag in S side 8" Apple S65°W 57.84
 O.C. Remon. Nail & tag in W side 30" Maple S10°W 168.39
 Or CL Kenowa Avenue

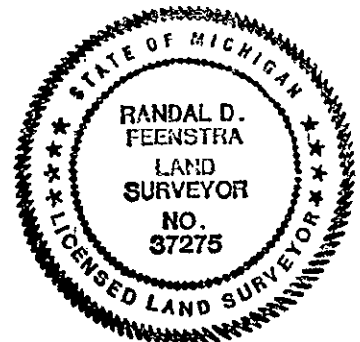

Signed by Randal D. Feenstra

Date July 13, 1994

Surveyor's Michigan License No. 37275