

SURVEY & REMONUMENTATION

APR 29 1996

COMMISSION

JUDITH D. ROEHM
 Ontonagon County
 LC 3/308 JEM Fee: 9.00
 Date 09/22/95 08:34
 Page 1 of 1

LAND CORNER RECORDATION CERTIFICATE
 Filing Requirement of Act 74, Mich. P.A. 1970

For corners in ONTONAGON Located In: _____ Corner Code # _____
 (County)

- 1. Public Land Survey T 48 R 40 E-12
 T _____ R _____
 T _____ R _____
 T _____ R _____
- 2. Property Controlling S _____ T _____ R _____
 in Section S _____ T _____ R _____
- 3. Miscellaneous S _____ T _____ R _____
 Property in Section S _____ T _____ R _____

Register of Deeds Stamp & File Number

- 4. Lot No. _____, Recorded Plat _____
- 5. Private Claims _____

$\frac{1}{4}$ Corner common to Sections 32 & 33, T48N R40W

I, Earl W. Applekamp, in a field survey on August 03, 19 95, do hereby certify that under requirements of P.A. 74, Michigan P.A. of 1970, the corner points mentioned in lines 1 and 2 above were in conformance with regulations and rules therefore as required in the current manual of survey instructions of the United States Department of the Interior, Bureau of Land Management or by a decree of a Court of Law and/or that the corner points mentioned in lines 3, 4 and 5 above were in conformance with the rules of the Michigan Board of Professional Surveyors or by a Decree of a Court of Law; established, re-established, monumented, re-monumented, recovered, found as expressed below:

| | | | | | | | | | | | | |
|----|----|----|----|----|----|----|---|---|---|---|---|---|
| A | B | C | D | E | F | G | H | I | J | K | L | M |
| 2 | 6 | 5 | 4 | 3 | 2 | 1 | | | | | | |
| 3 | | | | | | | | | | | | |
| 4 | 7 | 8 | 9 | 10 | 11 | 12 | | | | | | |
| 5 | | | | | | | | | | | | |
| 6 | 18 | 17 | 16 | 15 | 14 | 13 | | | | | | |
| 7 | | | | | | | | | | | | |
| 8 | 19 | 20 | 21 | 22 | 23 | 24 | | | | | | |
| 9 | | | | | | | | | | | | |
| 10 | 30 | 29 | 28 | 27 | 26 | 25 | | | | | | |
| 11 | | | | | | | | | | | | |
| 12 | 31 | 32 | 33 | 34 | 35 | 36 | | | | | | |
| 13 | | | | | | | | | | | | |

NOTE: Not more than 4 corners, all in the same town and range, may be recorded on this certificate.

A. Description of original monument and accessories and/or subsequent restoration:

Original corner established by Wills Burt, U.S. Deputy Surveyor, June 1857. Set Post.

BEARING TREES:

White Pine 20" S28°W 11 links (7.26 feet)
 Sugar 8" N50°E 6 links (3.96 feet)

B. Description of corner evidence found and/or method applied in restoring or reestablishing corner:

No original evidence of the corner was found. Corner position is on a township road which is graveled. Corner was set by single proportionate measurement between NE and SE Corner of Section 32. The East-West position was set on the centerline of the gravel road, as there was a distinct direction change at this position. Corner was monumented as described in "C" below.

PEER GROUP APPROVED
Earl W. Applekamp 9-20-95
 COUNTY REPRESENTATIVE

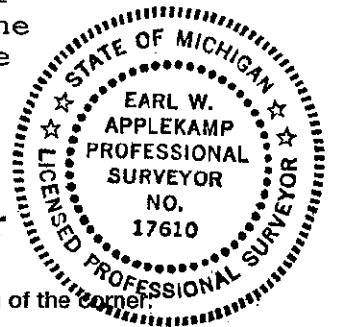

C. Description of monument for corner and accessories established to perpetuate locating the position of the corner:

At the corner position I set a 5/8"x24" rebar with a 3/4" brass cap 4" below top of gravel road. Cap is stamped to read: COUNTY REMONUMENTATION, T48N R40W, $\frac{1}{4}$, S32, S33, 1995, P.S. 17610. I established the following bearing trees, objects and witness corner.

10" Aspen N21°W 103.49 feet - REA P. Pole S10°E 152.23 feet
 REA P. Pole N12°E 179.73 feet - 1/2"x30" Alum. pipe W.C. East 28.35 feet
 Steel Sign Post East 29.15 feet

Signed by Earl W. Applekamp Date September 20, 1995
 Surveyor's Michigan License No. 17610

308