

**LAND CORNER RECORDATION CERTIFICATE**  
**Filing Requirement of Act 74, Mich. P.A. 1970**

For corners in

Ontonagon

(County)

Located In:

Corner Code #

**1. Public Land Survey**

T \_\_\_ R \_\_\_  
 T \_\_\_ R \_\_\_  
 T \_\_\_ R \_\_\_  
 T \_\_\_ R \_\_\_

**2. Property Controlling in Section**

S 24 T 51N R 37W 11  
 S 24 T 51N R 37W 10

**3. Miscellaneous Property in Sec.**

S \_\_\_ T \_\_\_ R \_\_\_  
 S \_\_\_ T \_\_\_ R \_\_\_

Register of Deeds Stamp & File Number

4. Lot No. \_\_\_\_\_, Recorded Plat \_\_\_\_\_

5. Private Claims \_\_\_\_\_

Sep 21 2004

I, Stephan J. Szyszkoski, in a field survey on \_\_\_\_\_, 20\_\_ do hereby state that under requirements of P.A. 74, Michigan P.A. of 1970, the corner points mentioned in lines 1 and 2 above were in conformance with regulations and rules therefore as required in the current manual of survey instructions of the United States Department of the Interior, Bureau of Land Management or by a decree of a Court of Law and /or that the corner points mentioned in lines 3, 4 and 5 above were in conformance with the rules of the Michigan Board of Land Surveyors or by a Decree of a Court of Law; established, re-established, monumented, recovered, found as expressed below:

NOTE: Not more than 2 corners, all in the same town and range, may be recorded on this certificate.

	A	B	C	D	E	F	G	H	I	J	K	L	M
1													
2	6		5		4		3		2		1		
3													
4	7		8		9		10		11		12		
5													
6	18		17		16		15		14		13		
7													
8	19		20		21		22		23		24		
9													
10	30		29		28		27		26		25		
11													
12	31		32		33		34		35		36		
13													

A. Description of original monument and accessories and/or subsequent restoration:  
 (11-Sec. 24) Southwest 1/16 corner, Section 24. Not established in the original survey.  
 (10-Sec. 24) South 1/16 corner between Sections 23-24. Not established in the original survey.

B. Description of corner evidence found and/or method applied in restoring or reestablishing corner:

(11-Sec. 24) Established the corner at the intersection of straight lines connecting opposite 1/16 corners.  
 (10-Sec. 24) Established the corner midway and on line between Quarter corner 1337.28' north and Section corner 1337.28' south.

C. Description of monument for corner and accessories established to perpetuate locating the position of the corner:

(11) Set 1"IDx32" I.pipe with 4" alum. MONR cap. Set measuring nails with tags in: 16" Y.Birch N48E 14.6' mrkd "1/16S BT" 15" Sugar S83E 29.5' do 12" Y.Birch S50W 33.8' do 16" Hemlock N76W 30.1' do Set sq'd cedar post adjacent. Bearings are magnetic. Distances are to nail with tag.	(10) Set 1"IDx32" I.pipe with 4" alum. MONR cap. Set measuring nails with tags in: 7" Maple N15E 9.5' mrkd "1/16S BT" 13" Sugar S43E 4.9' do 8" Sugar S45W 21.1' do 6" Sugar N65W 15.2' do Set sq'd cedar post adjacent. Bearings are magnetic. Distances are to nail with tag.
---	--

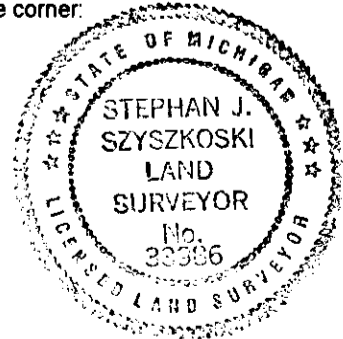

Signed by Stephan J. Szyszkoski  
 Surveyor's Michigan License No. 33986

Date 11/3/04