

LAND CORNER RECORDATION CERTIFICATE  
 Filing Requirement of Act 74, Mich. P.A. 1970

H. D. ROEHN  
 Mason County  
 LC 4/283 JJT Fee: 9.00  
 06/13/97  
 15:28  
 Page 1 of 1

For corners in

Ontonagon Located in: Corner Code #  
 (County)

1. Public Land Survey T 51N R 40W A-10 Same  
 T 51N R 41W M-10 Corner  
 T \_\_\_ R \_\_\_  
 T \_\_\_ R \_\_\_  
 2. Property Controlling S \_\_\_ T \_\_\_ R \_\_\_  
 in Section S \_\_\_ T \_\_\_ R \_\_\_  
 3. Miscellaneous S \_\_\_ T \_\_\_ R \_\_\_  
 Property in Sec. S \_\_\_ T \_\_\_ R \_\_\_
4. Lot No. \_\_\_\_\_, Recorded Plat \_\_\_\_\_  
 5. Private Claims \_\_\_\_\_

REMONUMENTATION  
 OCT 3 1997  
 Register of Deeds Stamp & File Number

I, Joseph C. Domitrovich, in a field survey on June 4, 19 97 do hereby state that under requirements of P.A. 74, Michigan P.A. of 1970, the corner points mentioned in lines 1 and 2 above were in conformance with regulations and rules therefore as required in the current manual of survey instructions of the United States Department of the Interior, Bureau of Land Management or by a decree of a Court of Law and/or that the corner points mentioned in lines 3, 4 and 5 above were in conformance with the rules of the Michigan Board of Land Surveyors or by a Decree of a Court of Law, established, re-established, monumented, recovered, found as expressed below:

NOTE: Not more than 2 corners, all in the same town and range, may be recorded on this certificate.

	A	B	C	D	E	F	G	H	I	J	K	L	M
1													
2	6		5		4		3		2		1		
3													
4	7		8		9		10		11		12		
5													
6	18		17		16		15		14		13		
7													
8	19		20		21		22		23		24		
9													
10	30		29		28		27		26		25		
11													
12	31		32		33		34		35		36		
13													

(A-10/M-10) 1/4 Corner Common to Sections 30 and 25, T 51N, R40/41W

A. Description of original monument and accessories and/or subsequent restoration:

- 1845 - Austin Burt, D.S., set post  
 6" Maple S 15° E 16 links  
 8" Black Ash N 15° W 24 links

B. Description of corner evidence found and/or method applied in restoring or reestablishing corner:

Original corner and accessories have been destroyed by road construction and farming. I accepted the intersection of an old fallen fence to the west and the centerline of Townline Road as the 1/4 corner position. Bill Myhren, a resident of Townline Road area told me that Townline Road was already in place when his family moved to their farm in 1919. The above mentioned fence was built shortly afterward. A Mr. Hannah, of Greenwood Lumber Company, surveyed the line for the placement of the fence. I also found a 1 1/2" galvanized pipe and Champion International tag opposite corner position in the woods indicating that the corner is in the Road.

Research on file with County Remonumentation Representative.

C. Description of monument for corner and accessories established to perpetuate locating the position of the corner:

Corner is a 5/8" iron pin with a 3" diameter aluminum cap stamped to read: COUNTY REMONUMENTATION T. 51N R. 40W, R. 41W; 1/4; S. 25, S. 30; 1997; P.S. 37273. I also placed a reference monument (R. M.) to the West, a 2" (30' diameter) pipe with a 3" diameter aluminum cap, stamped to indicate that the corner is East 53.55'.

- 6" Soft Maple N 38° E 68.92'  
 1 1/2" Galv. Pipe S 89° 47' 22" E 46.56'  
 6" Soft Maple S 67° E 67.88'  
 4" Soft Maple S 61° W 59.45'  
 Reference Monument N 89° 36' 47" W 53.55'  
 NW Corner Sec. 30 N 00° 12' 06" E 2645.10'  
 SW Corner Sec. 30 S 00° 39' 15" W 2634.90'

PEER GROUP APPROVED  
*Paul W. Applbaum*  
 COUNTY REPRESENTATIVE 6-6-97

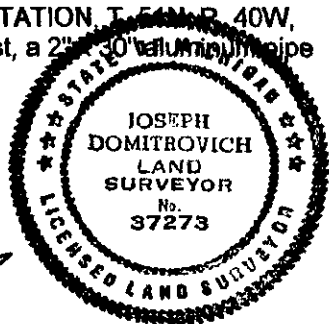

NOTE: Bearings are magnetic. Distances are to nail in side of witness objects unless noted.

Signed by Joseph C. Domitrovich Date 6/9/97  
 Surveyor's Michigan License No. 37273