

MICHIGAN  
DEPARTMENT OF CONSERVATION  
FORESTRY DIVISION

# LAND CORNER RECORD

T. 51N N.R. 41W

Ontonagon COUNTY

DESCRIPTION OF CORNER Section Corner common to Sections 2-3-10-11

CORNER MONUMENT 1" Iron Rod driven in at lake shore.

DATE MONUMENT PLACED AND WITNESSED 9/16/65

WITNESSES TO CORNER..... 8" Soft Maple S78°E 69.0'

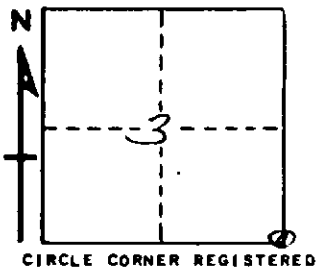

5" Soft Maple S35°E 35.2'

AND

DESCRIPTION IN DETAIL AS TO HOW CORNER WAS LOCATED AND IDENTIFIED OR RESTORED.

Re-witnessed corner as found.

Believe this iron to have been set by Mr. Wilcox,  
County Road Engineer about 1930.

As an additional witness;  
placed a  $\frac{1}{2}$ " x 36" Iron (buried) 15.0' South of  
Section Corner.

Noted bearings and distance to:  
8" W. Birch N74°W 8.6'  
5" Soft Maple (Wit:tree) S55°E 24.6'  
8" Soft Maple " S88°E 66.8'

SURVEYOR'S SEAL

SIGNED Billy D. Buckler DATE 2/28/68  
REGISTERED LAND SURVEYOR