

LAND CORNER RECORDATION CERTIFICATE
Filing Requirement of Act 74, Mich. P.A. 1970

For corners in

Table with columns: Located in: (Presque Isle), Corner Code # (F-9), and numbered items 1-5 describing survey types and section locations.

Recorded Dec. 16, 1999
At 11:30 o'clock A.M.
Janet M. Lamb
Reg. of Deeds, Presque Isle Co. MI

Register of Deeds Stamp & File Number

4. Lot No. , Recorded Plat
5. Private Claims

Ronald Bischer, in a field survey on Aug. 20, 1999 do hereby state that under requirements of P.A. 74, Michigan P.A. of 1970, the corner points mentioned in lines 1 and 2 above were in conformance with regulations and rules therefore as required in the current manual of survey instructions of the United States Department of the Interior, Bureau of Land Management or by a decree of a Court of Law and /or that the corner points mentioned in lines 3, 4 and 5 above were in conformance with the rules of the Michigan Board of Land Surveyors or by a Decree of a Court of Law; established, re-established, monumented, recovered, found as expressed below:

Grid table with columns A-M and rows 1-13, containing numbers 1-36 and a dot in cell G9.

NOTE: Not more than 2 corners, all in the same town and range, may be recorded on this certificate.

A. Description of original monument and accessories and/or subsequent restoration:

F-9
1856 GLO Notes
N45°E 9.9 lks 30" W. pine
S30°W 7.9 lks 4" W. Birch
Aug. 1, 1980 Danny Bongiovanni #24586
set 5/8" rod and cap #24586
S75°W 38.65' 2 10" Maples
S05°E 43.81' 12" W. Birch
March 25, 1994 Ronald Bischer #22428
set 1/2" rod and cap #22428 off from
original 30" pine stump
N02°W 35.85' 5" W. Pine
S53°E 33.65' 12" Maple
S15°W 32.11' 12" W. Birch
S20°W 50.45' 14" Oak

B. Description of corner evidence found and/or method applied in restoring or reestablishing corner:

F-9
Aug. 20, 1999 Presque Isle County Remonumentation
Ronald Bischer #22428
found 1/2" rod and cap #22428
found 4 witnesses

C. Description of monument for corner and accessories established to perpetuate locating the position of the corner:

F-9
1/2" rod and cap #22428
N02°W 36.00' 5" W. Pine
S47°E 33.65' 12" Maple
S19°W 32.11' 12" W. Birch
S24°W 50.45' 14" Oak

Chairman Norman J. Dean
Date 11/30/99

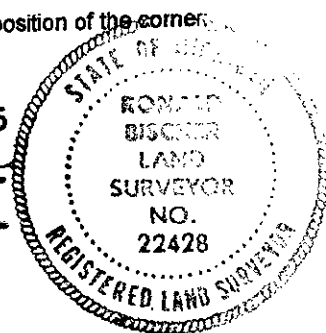

Signed by Ronald E. Bischer
Surveyor's Michigan License No. 22428

Date 12-13-99