

DEC 29 1999

LAND CORNER RECORDATION CERTIFICATE
Filing Requirement of Act 74, Mich. P.A. 1970

SECTION

For corners in

Presque Isle
(County)

Located In:

Corner Code #

1. Public Land Survey

T 34N R 4E F-11 ✓

T R

T R

T R

2. Property Controlling
in Section

S T R

S T R

3. Miscellaneous
Property in Sec.

S T R

S T R

Recorded

Dec. 16, 1999

At 11:30 o'clock A.M.

Janet M. Lamb
Reg. of Deeds, Presque Isle Co. MI

Register of Deeds Stamp & File Number

4. Lot No. _____, Recorded Plat _____

5. Private Claims _____

	A	B	C	D	E	F	G	H	I	J	K	L	M
1													
2	6	5	4	3	2	1							
3													
4	7	8	9	10	11	12							
5													
6	18	17	16	15	14	13							
7													
8	19	20	21	22	23	24							
9													
10	30	29	28	27	26	25							
11													
12	31	32	33	34	35	36							
13													

I, Ronald Bischer, in a field survey on Aug. 20, 1999 do hereby state that under requirements of P.A. 74, Michigan P.A. of 1970, the corner points mentioned in lines 1 and 2 above were in conformance with regulations and rules therefore as required in the current manual of survey instructions of the United States Department of the Interior, Bureau of Land Management or by a decree of a Court of Law and /or that the corner points mentioned in lines 3, 4 and 5 above were in conformance with the rules of the Michigan Board of Land Surveyors or by a Decree of a Court of Law; established, re-established, monumented, recovered, found as expressed below:

NOTE: Not more than 2 corners, all in the same town and range, may be recorded on this certificate.

A. Description of original monument and accessories and/or subsequent restoration:

F-11
1856 GLO Notes
N33°E 22 lks 9" Hemlock
S32°W 20 lks 9" Cedar
1964 R.S. Scott Associates
2" Pipe
N20°W 36.21' 15" Larch
S10°W 32.58' 20" Balsam
S40°E 57.60' 8" Maple

Aug. 30, 1978 Delmer Porter #15410
1/2" rod and cap in mon box
set by Scotts witnesses
N05°E 47.23' Conc. Mon
S29°E 49.36' 8" Cedar
S26°W 45.49' 10" Cedar

B. Description of corner evidence found and/or method applied in restoring or reestablishing corner:

F-11
Aug. 20, 1999 Presque Isle County Remonumentation
found 1/2" rod and cap in mon box #15410
found 3 old witnesses

C. Description of monument for corner and accessories established to perpetuate locating the position of the corner:

F-11
1/2" rod and cap #15410 in mon box
S29°W 45.42' 14" Cedar
S23°E 49.22' 15" Cedar
N09°E 47.20' Conc. project marker
N18°W 70.56' 15" Oak

Ratified by Peer Group
in accordance with P.A. 945
Chairman Norman [Signature]
Date 11/30/99

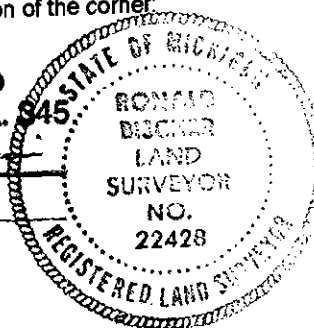

Signed by Ronald K. Bischer
Surveyor's Michigan License No. 22428

Date 12-13-99